

BT-CSPA

Arterial Puncture Training Model

USER GUIDE

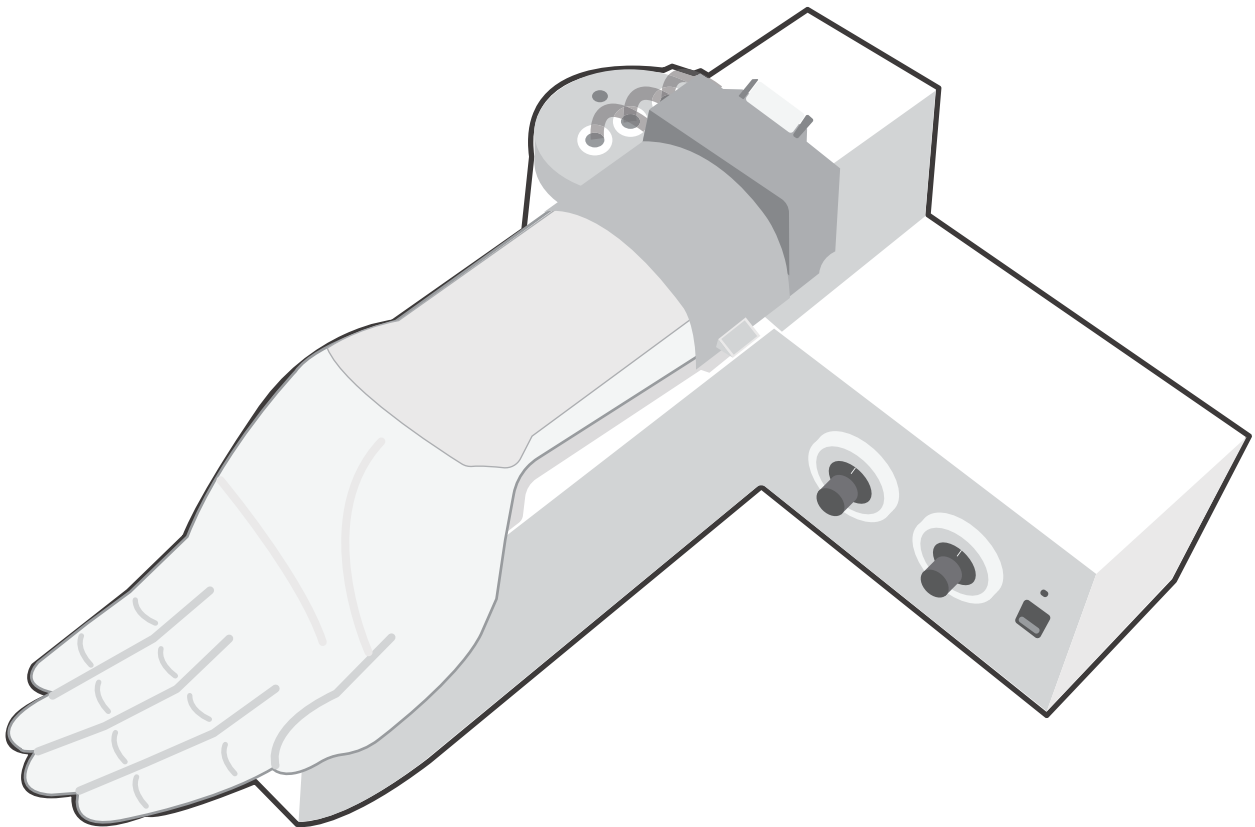

User Guide



English

Product Information

Product Name	Arterial Puncture Training Model
Model Name	BT-CSPA
Manufacturer	BT Inc.
Country of Origin	Republic of Korea
Certification	

Product Specification

Dimensions	307 X 367 X 169mm
Weight	2.8 kg
Power Converter	Input AC100-240~, 50/60Hz, 0.4A Output DC 12V, 1.5A
Battery	8EA of LR6 (AA, 1.5V)

Customer Service

Website	www.btinc.co.kr
Address	A-313, Samsung Techno-valley, 140, Tongil-ro, Deogyang-Gu, Goyang-Si, Gyeonggi-do, 10594, Republic of Korea
Telephone	+82-2-2038-2903
E-mail	bt@btinc.co.kr



Cautions for battery disposal

- * Please follow the regulations of corresponding area for the disposal of used batteries.

Cautions

Please read it carefully to ensure correct usage and user's safety through understanding of the product.

- ① Use only components provided or approved by BT Inc.
- ② Do not use the product for other purposes described in this manual.
- ③ If you disassemble or modify the product without any permission by BT Inc, you cannot get the warranty. Also, making imitated or altered products for commercial purposes are prohibited by law.
- ④ During the usage, please contact us after any electricity power off when the product is overheated or smelled something burning
- ⑤ Keep the product away from water or moisture. If the product gets wet, do not turn it on.
- ⑥ Do not use the product near strong magnetic fields or high voltage power lines.
The product might malfunction due to the electromagnetic waves.
- ⑦ Do not use the product under a weather of lightning. It can cause the product malfunction and increases the risk of electric shock
- ⑧ Do not use the product with temperatures below 0°C or above 40°C
(Operation temperature : 0°C ~ 40°C, Storage temperature : -10°C ~ 50°C)
- ⑨ Do not keep the product near hot places such as heaters. Deterioration of product or internal damage might occur
- ⑩ Never clean the product with chemical substances such as solvent, benzene or thinner, as these may Cause ignition or cause the surface deterioration.
- ⑪ BT Inc. can change or adjust the product specification without any notice in order to improve the product.

Components

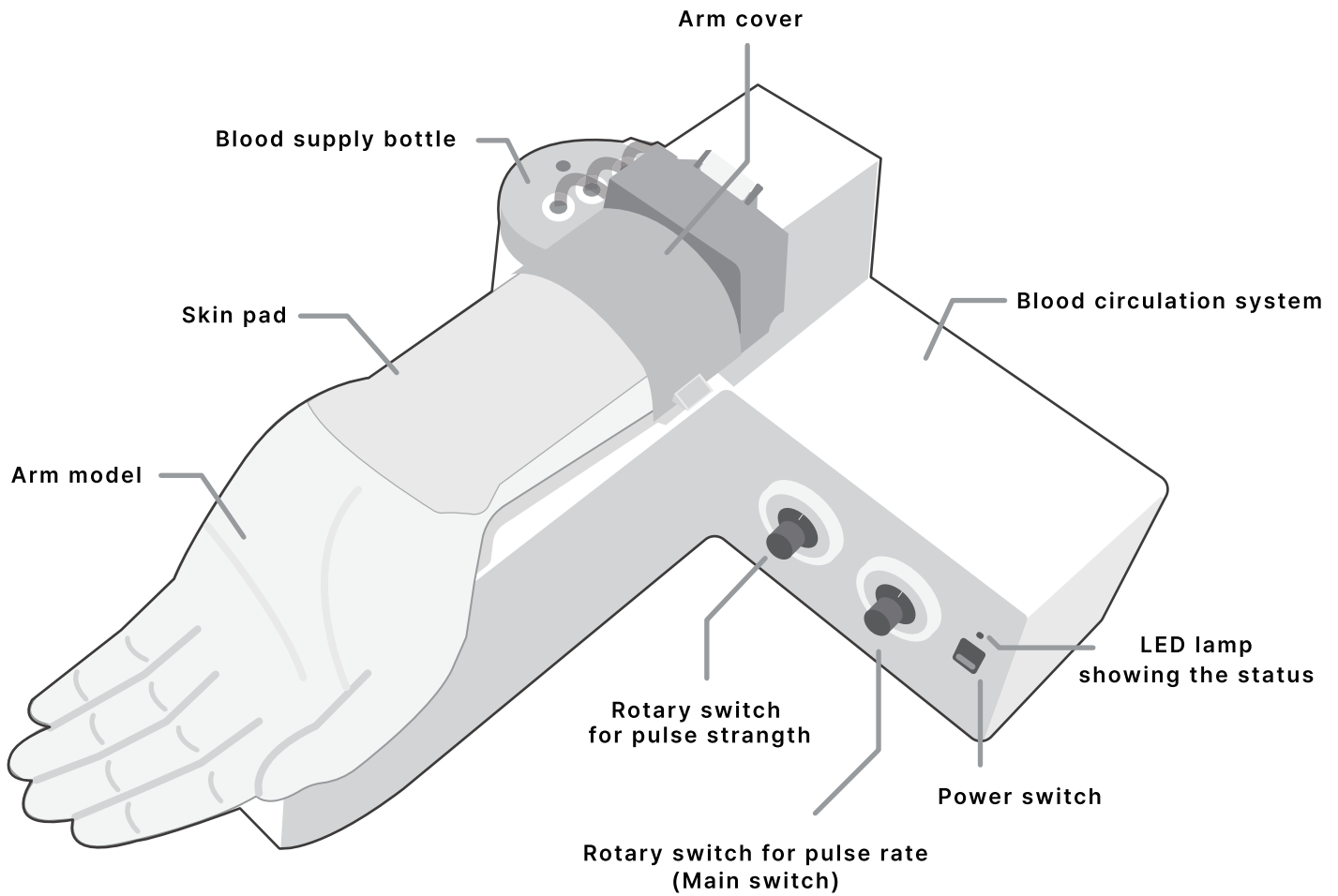

* etc - Power adapter, Simulated blood, Storage bag

Consumables	
<ul style="list-style-type: none"> • Skin pad • Simulated blood 	

Recommended Clinical Supply Sizes	
Needle	1cc~3cc, 24G

- The following clinical supply sizes are recommended for use with our Arterial Puncture Training Model.
- Other sizes may cause damage to the products.
- Lifetime of the consumables may differ depending on the skill level of the users.

Connecting the power supply

(1) How to connect the power adapter

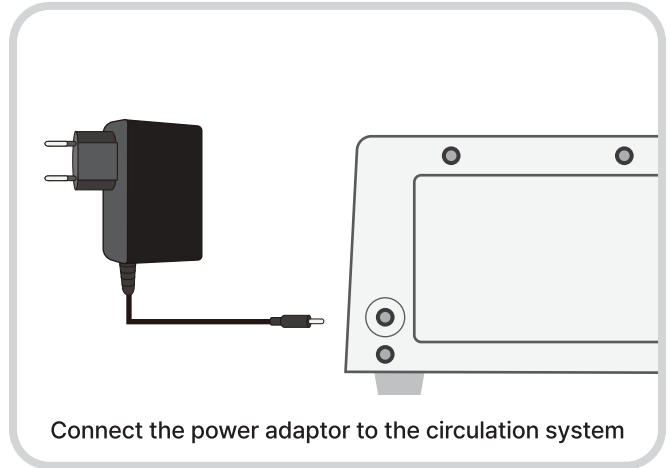
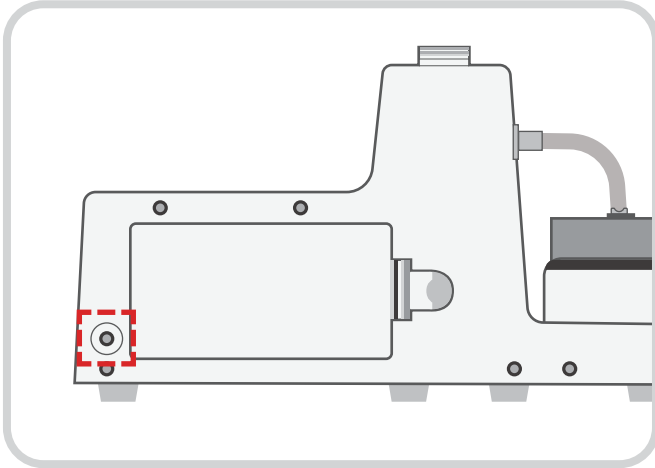

- Please use the included power adapter.

(2) How to Insert batteries

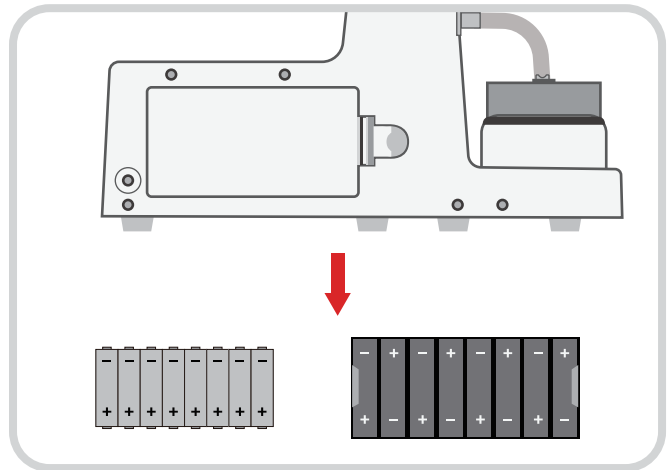
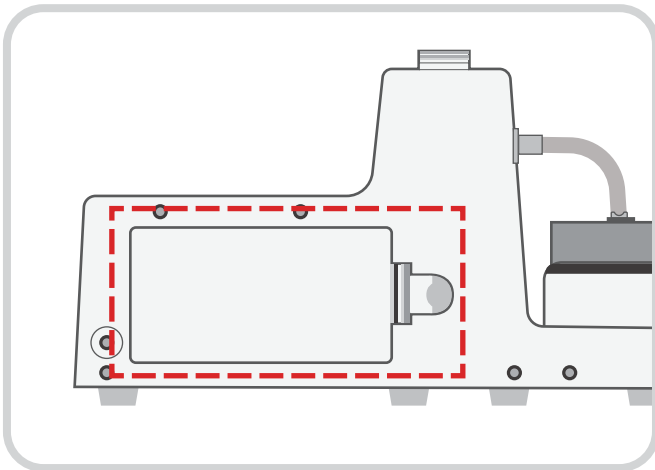

- Open the battery cover at the back side of the circulation system.
- Insert 8 batteries in to the battery holder with (+) and (-) electrodes aligned.
- Use the LR(AA type, 1.5V) batteries.
- The LED lamp will flicker when the battery is low.
- Please turn the power off before changing batteries to prevent any malfunctions.

Installation

(1) Installation of product

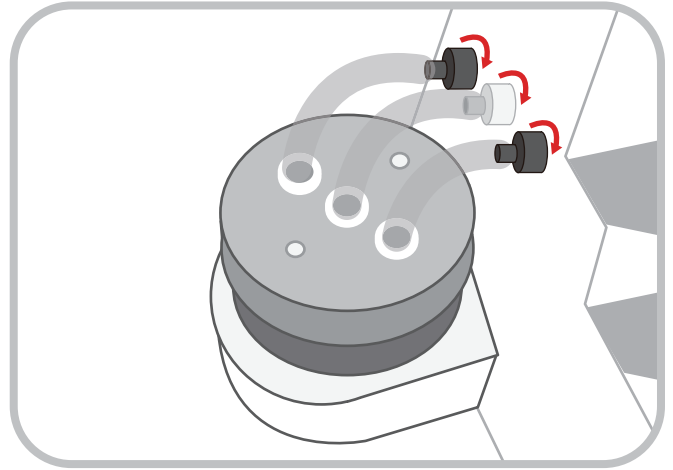
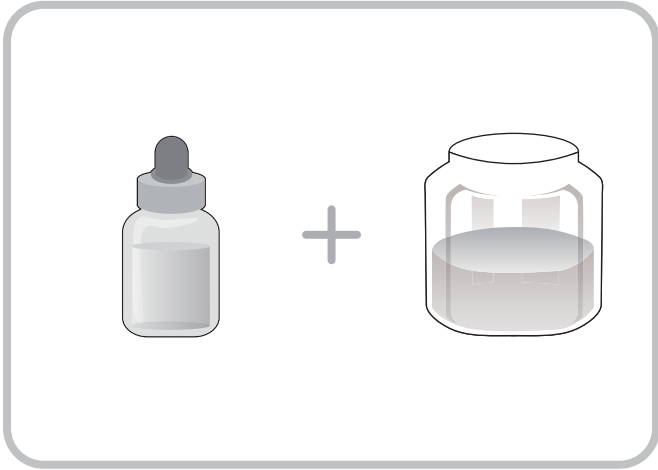

- Fill the blood supply bottle half with water and add some drops of simulated blood.
- Place the blood supply bottle on the circulation system.
- Connect all connectors as shown. (Rotate the tips until you hear a click.)

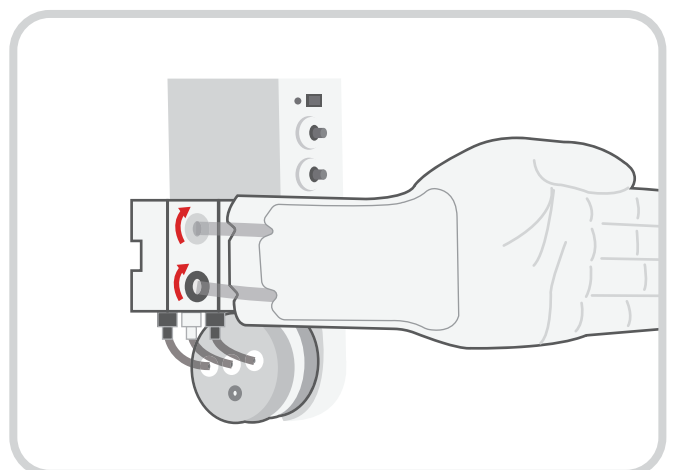
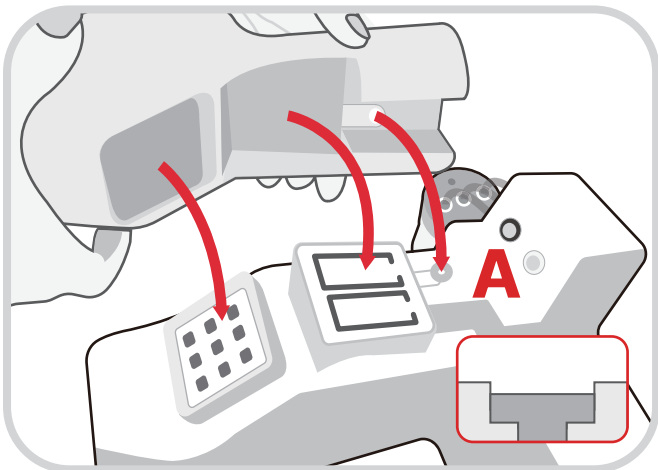

- Place the arm on the circulation system and assemble them.
(Insert the arm fully into the round hole of the A part.)
- Insert the skin pad into the arm and connect the tube connectors. (Rotate the tips until you hear a click.)
- Place the arm cover on the arm.
(When product is released from BT factory, the skin pad is already conneted to the arm.)
- Connect the power adapter.(Please refer to "How to connect the power supply" page.)

(2) Operation

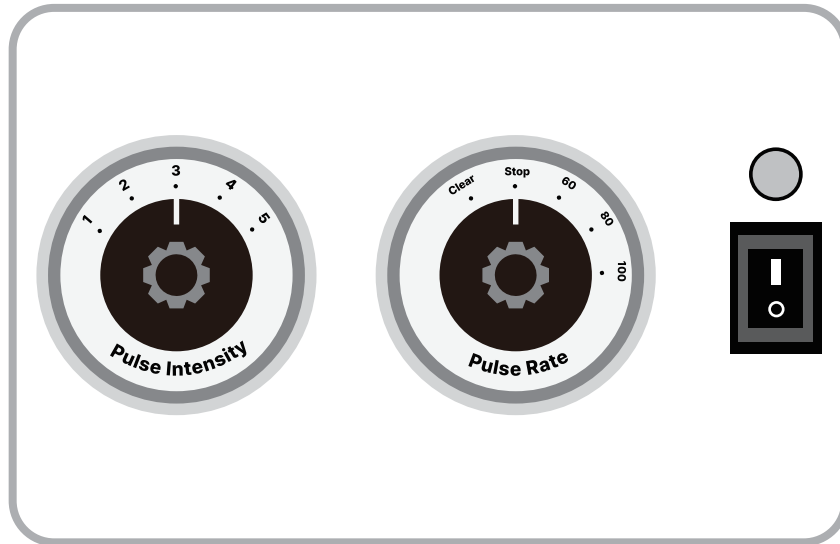

- Make sure the power is being supplied, and turn the power on.
- Set the pulse rate switch(Main switch) to the value that you want to practice.
- 3 stages : 60, 80 ,100 BPM
- Circulate the blood about 3 seconds so that the blood can be filled to the vein.
- Set the pulse strength switch for the trainer.
- 5 stages : 1(Min.) ~ 5(Max.)
- After training, set the pulse rate switch to STOP.
- The circulation system will work about 5 seconds to collect the blood inside of vein.

<LED lamp showing the status>

Status of system	LED lamp showing the status	Lamp
Power On	Red light ► Green light ► Blue light ON	
Set pulse rate switch to 60/80/100	Blue light flickering 3 seconds and ON	
Set pulse rate switch to Stop	Green light flickering 5 seconds and Blue light ON	
Set pulse rate switch to Clear	Green light ON	
Low battery	Red light flickering	

* The LED lamp will flicker when the battery is low. Turn the power off and change the batteries.

Functions

<Allen's test>

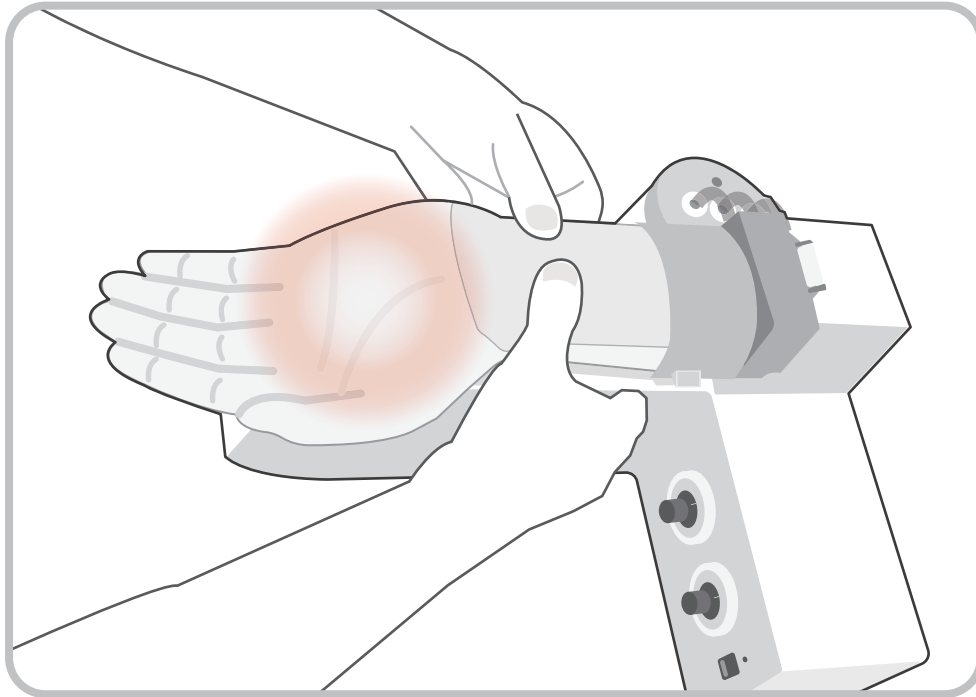

- Perform Allen's test with the model.
- You can check the color of palm is changing.

<Arterial Puncture Training>

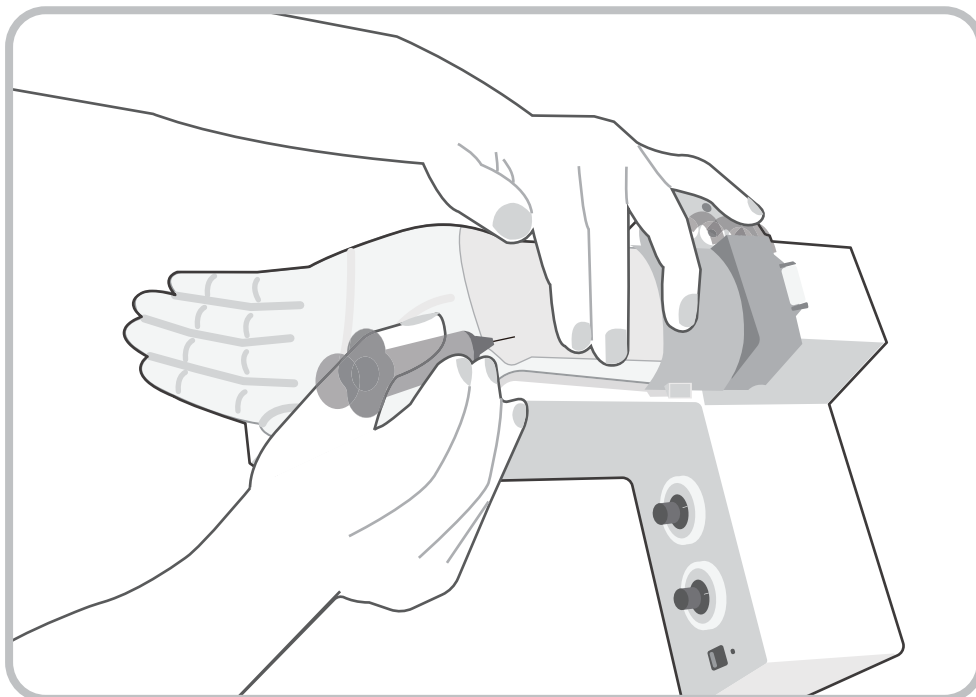

- Find the radial artery and perform the arterial puncture.
- You can check the back flow of blood due to arterial pressure.

Cleaning and Storage

(1) How to clean the model

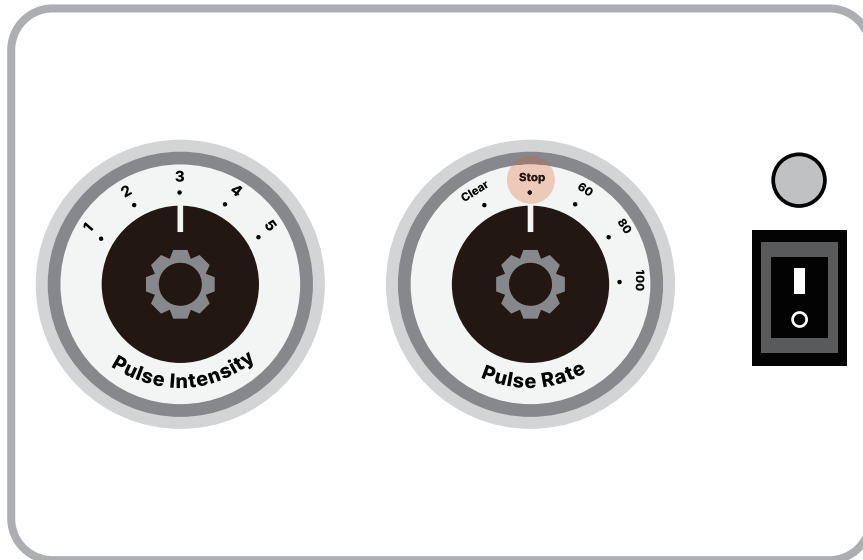

- Set the pulse rate switch to STOP.
- Disassemble the blood supply bottle from the circulation system and wash it.
- Fill the blood supply bottle half with water and re-connect it to the system.
- Set the pulse rate switch to CLEAR.
- After cleaning the vein enough, set the rotary switch for pulse rate to STOP.
- Disassemble the blood supply bottle from the circulation system and wash it.
- Repeat below steps 2~3 times.

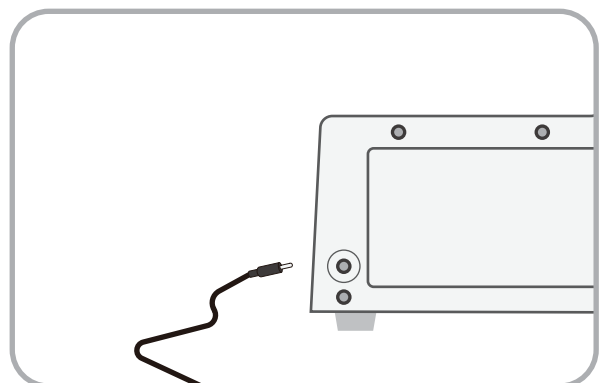

- After taking out the skin pad, wipe the arm with a clean soft cloth.
- Replace the blood supply bottle and skin pad on the circulation system.
- Turn the power off and disconnect the power adaptor.
- Store in a storage place.

(2) Replacement of the skin pad

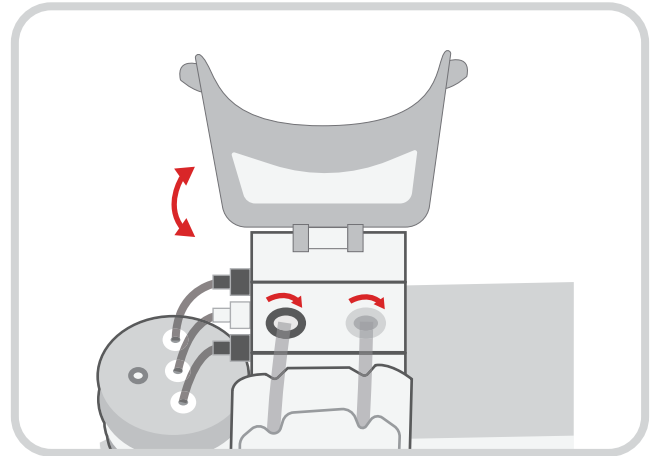
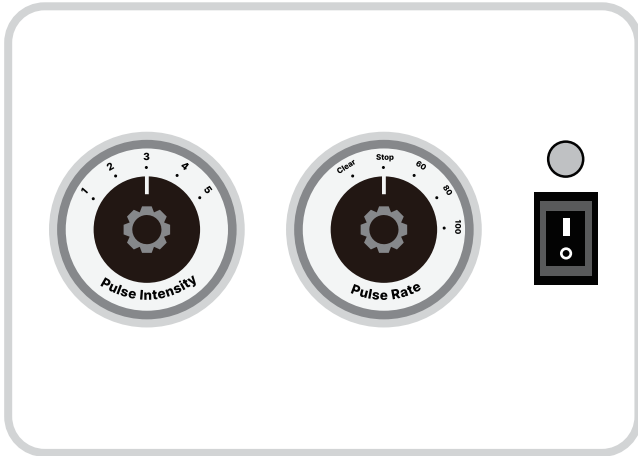

- 1) Set the pulse rate switch to STOP.
- 2) Turn the power off. (Do not try to replace the skinpad while the power is on.)
- 3) Open the arm cover and disconnect the tube connectors and take the skin pad out.
- 4) Wipe the arm with a clean soft cloth.
- 5) Prepare the new skin pad and insert the skin pad into the arm and connect the tube connectors.
(Rotate the tips until you hear a click.)
- 6) Replace the arm cover.

BT-CSPA

Arterial Puncture Training Model

A-313, Samsung Techno-valley, 140, Tongil-ro
Deogyang-gu, Goyang-si, Gyeonggi-do, 10594, Republic of Korea

Homepage: www.btinc.co.kr / E-mail: bt@btinc.co.kr
Tel: +82-2-2038-2903, +82-51-903-1144 / Fax: +82 303-3130-0607

Copyright(c) BT Inc. All rights reserved.