

BT-CSIP

Chemoport Injection Training Simulator

USER GUIDE

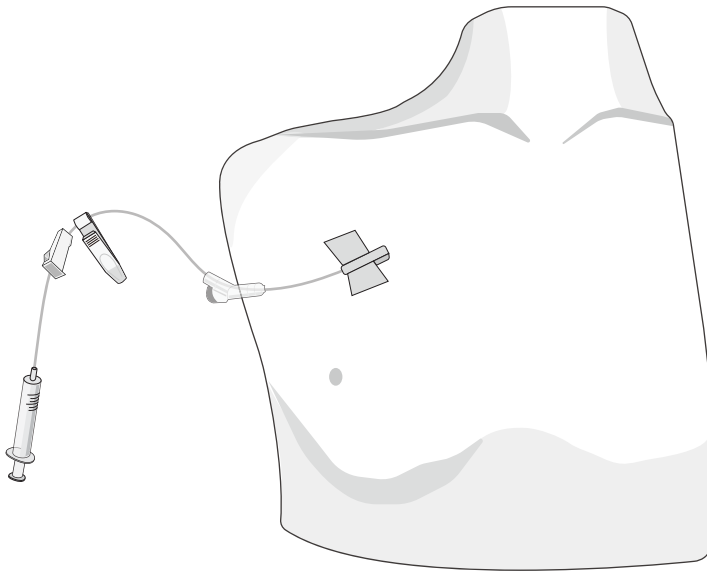

Product Information

Product Name	Chemoport Injection Training Simulator
Model Name	BT-CSIP
Manufacturer	BT Inc.
Country of Origin	Republic of Korea



(Contain FCC ID : 2APB6-BOT-NLE521)

Product Specification

Dimensions	280 X 245 X 140mm
Weight	1.3 kg
Power Converter	Input AC100-240V~, 50/60Hz, 0.4A Output DC 12V, 1.5A
Battery	5EA of LR6(AA, 1.5V)

Customer Service

Website	www.btinc.co.kr
Address	A-313, Samsung Techno-valley, 140, Tongil-ro Deogyang-Gu, Goyang-Si, Gyeonggi-do, 10594, Republic of Korea
Telephone	+82-2-2038-2903
E-mail	bt@btinc.co.kr



Cautions for battery disposal

- * Please follow the regulations of corresponding area of the disposal of used batteries

Cautions

Please read it carefully to ensure correct usage and user's safety through understanding of the product.

- Ⓞ Use only components provided or approved by BT Inc.
- Ⓞ Do not use the product for other purposes described in this manual.
- Ⓞ If you disassemble or modify the product without any permission by BT Inc, you cannot get the warranty. Also, making imitated or altered products for commercial purposes are prohibited by law.
- Ⓞ During the usage, please contact us after any electricity power off when the product is overheated or smelled something burning.
- Ⓞ Keep the product away from water or moisture. If the product gets wet, do not turn it on.
- Ⓞ Do not use the product near strong magnetic fields or high voltage power lines.
The product might malfunction due to the electromagnetic waves.
- Ⓞ Do not use the product under a weather of lightning. It can cause the product malfunction and increases the risk of electric shock.
- Ⓞ Do not use the product with temperatures below 0°C or above 40°C.
(Operation temperature : 0°C ~ 40°C, Storage temperature : -10°C ~ 50°C)
- Ⓞ Do not keep the product near hot places such as heaters. Deterioration of product or internal damage might occur.
- Ⓞ Never clean the product with chemical substances such as solvent, benzene or thinner, as these may cause ignition or cause the surface deterioration.
- Ⓞ BT Inc. can change or adjust the product specification without any notice in order to improve the product.

Components

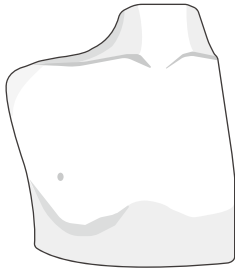

Torso Manikin

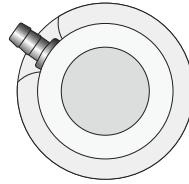

Simulated Ports - 5ea
(1ea embedded in the torso)



Drain tube



Drain bottle



Power Adapter

* etc. - Storage Case, Simulated Blood

Consumables

- Chest Skin
- Simulated Ports

Recommended Clinical Supply Sizes

Chemoport Needle

19G~22G

- The following clinical supply sizes are recommended for use with BT-CSIP model.
- Other sizes may cause damage to the products.
- Lifetime of the consumables may differ depending on the skill level of the users.

Features

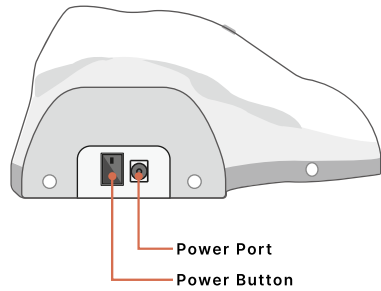
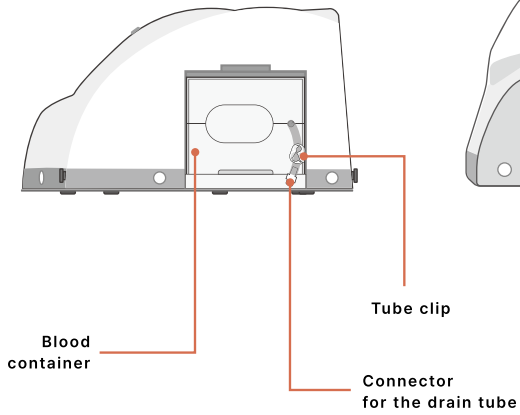
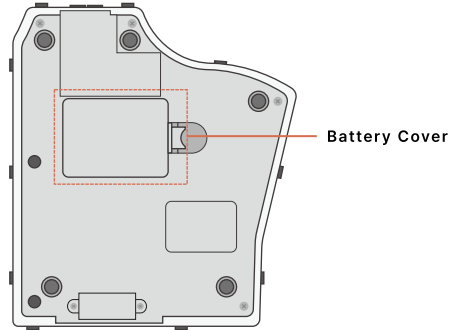
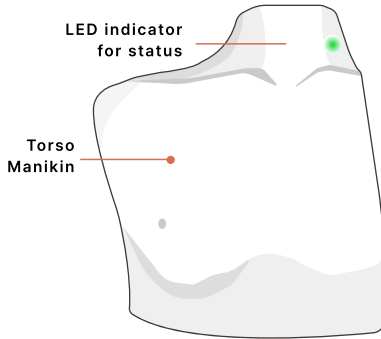

Power Connections

(1) Battery power supply

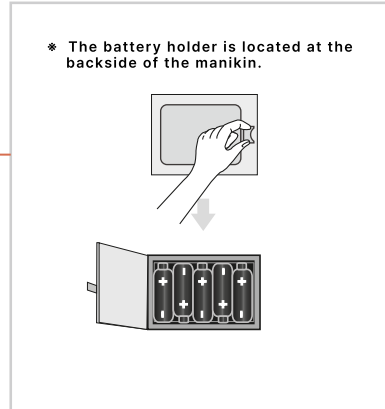
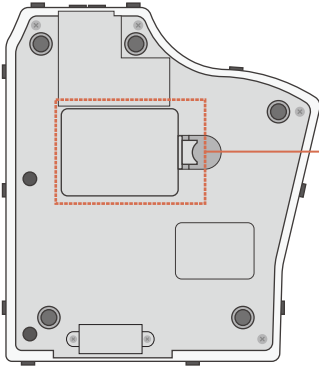

- ① Open the battery cover at the backside of the manikin by pressing the stoppers with both index fingers.
- ② Insert 5 batteries into the battery holder with correct polarities.
- ③ Use LR6(AA-type, 1.5V) standard batteries only.

* Make sure to remove the blood container before replacing the battery.

(2) External AC power supply

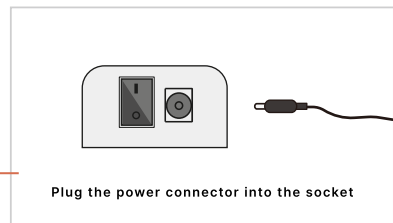
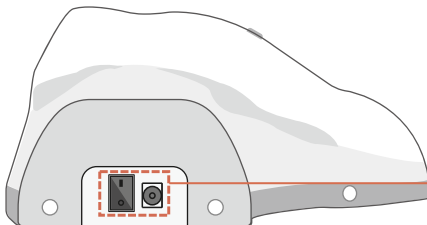

Plug the power connector into the socket

* Use only the power converter supplied by manufacturer.

Installation

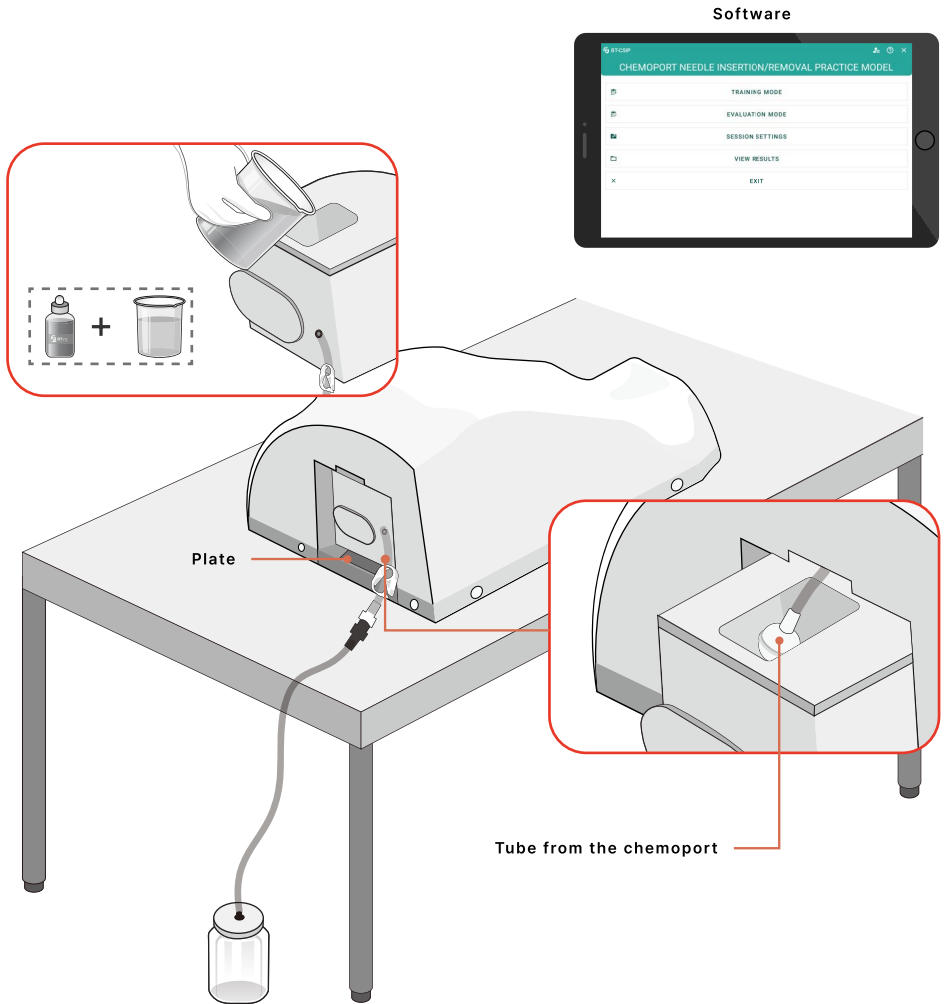

- ① Prepare the manikin.
- ② Press the plate of the blood container to detach it from the manikin.
- ③ Open the tube clip on the connector of the draining tube attached to the blood container.
- ④ Connect the connectors between the draining tube and the blood container.
- ⑤ Connect the drain tube to the drain bottle.
- ⑥ Add 100cc of water and 3-4 drops of simulated blood to the blood container.
- ⑦ Insert the tube from the chemo port into the blood container and assembly it to the manikin.
- ⑧ Turn on the power of the manikin, connect to the software and start the training.

Functions

(1) Needle insertion - LED ON

When the needle is inserted : Green LED ON

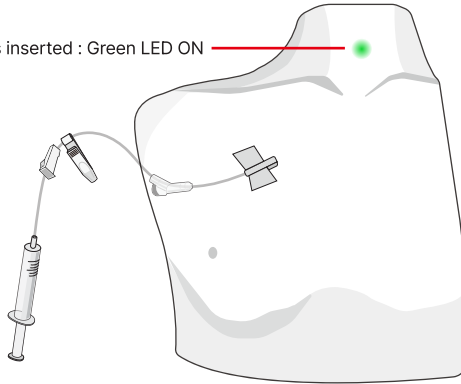

(2) Flushing - LED Blinking

When the fluid is being injected with a syringe : Green LED Blinking

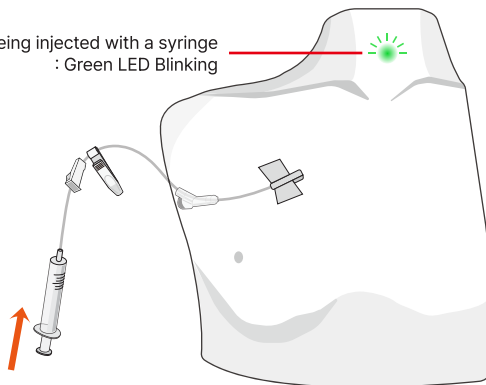

* It is integrated with software, allowing feedback to be reviewed through the software as well.

Cleaning and Storage

(1) Storage and Maintenance

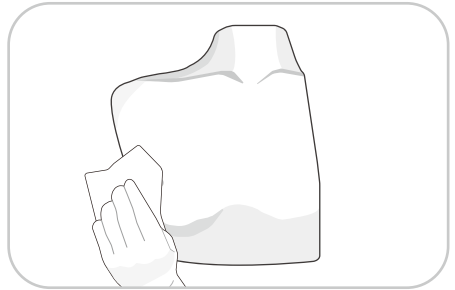
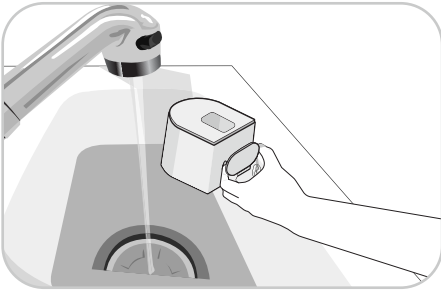
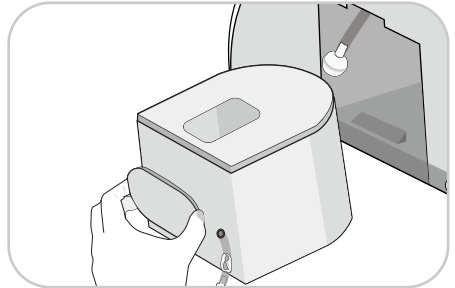
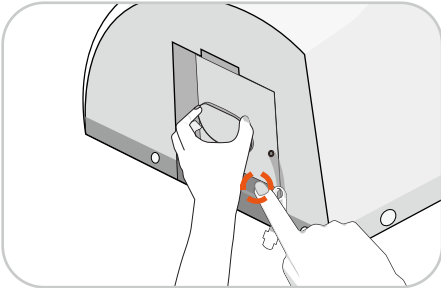
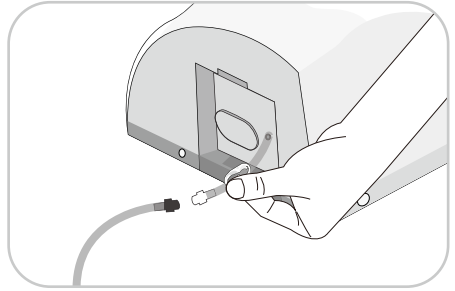
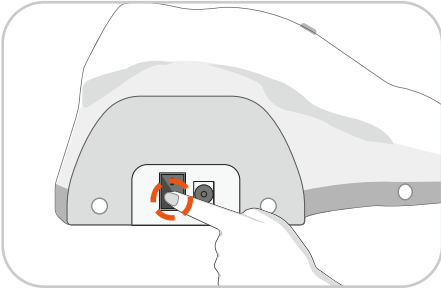

- Turn the manikin off after the training.
- Close the tube clip on the connector of the drain tube and disconnect the tube.
- Press the plate of the blood container and detach it from the manikin.
- Wash the blood container and drain bottle under running water.
- Dry the container with a clean, dry cloth and reattach it to the manikin.
- Wipe manikin with an alcohol swab or a soft cloth dampened with ethanol, then store it in the designated storage location.

(2) How to replace skin and simulated port

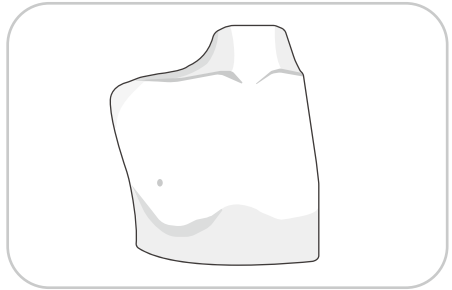
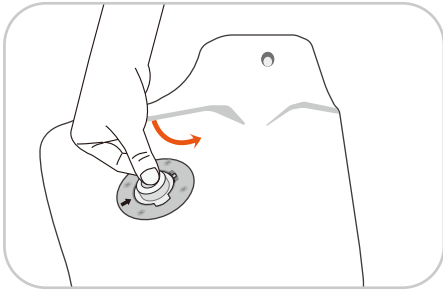
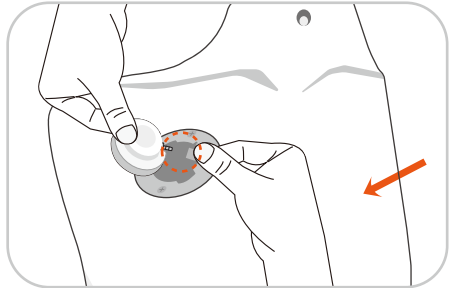
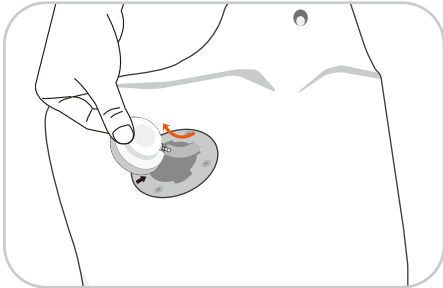
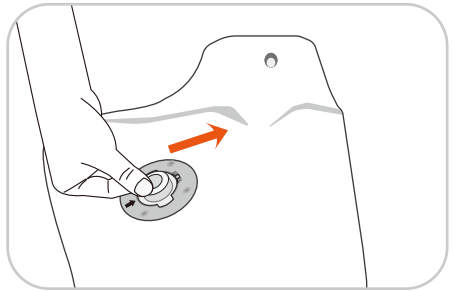
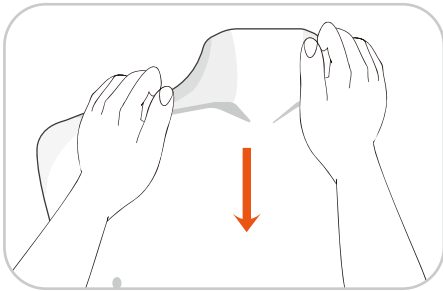

- Remove the skin from the manikin.
- Push the simulated port in the direction of the arrow to detach it, then lift it out.
- Disconnect the port from the tube.
- Connect the new port to the tube.
- Reassemble the parts in reverse order.

* The chest skin and port are consumable items.

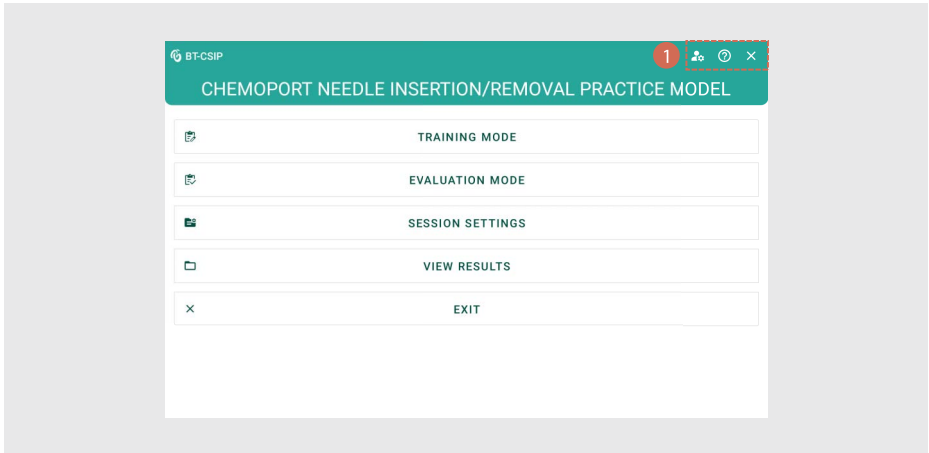

Software

1-1. Home



- The simulator features a Training Mode for repeated practice of session steps and an Evaluation Mode that integrates and saves trainees' results through practice assessments.
- The sessions used for training or evaluation are not only pre-installed but can also be edited or newly created to suit specific curriculums.
- The training model is equipped with sensors that detect needle insertion, flushing, and removal actions and data is transmitted via Bluetooth communication.
- Practice can also be conducted in Offline Mode, even without the manikin.

🕒 Icon

Icon	Description	Icon	Description
	Administrator		User manual
	Exit		

Administrator Account Settings

2-1. Registering an Administrator Password

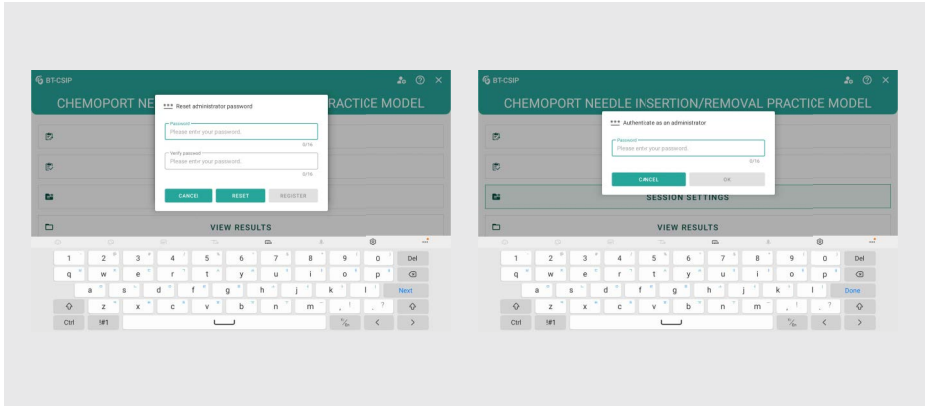

- Only administrators have the authority to modify sessions or manage evaluation results.
- By using the registered administrator password, administrators can be authenticated when accessing session settings and evaluation results.

2-2. Administrator Account Settings

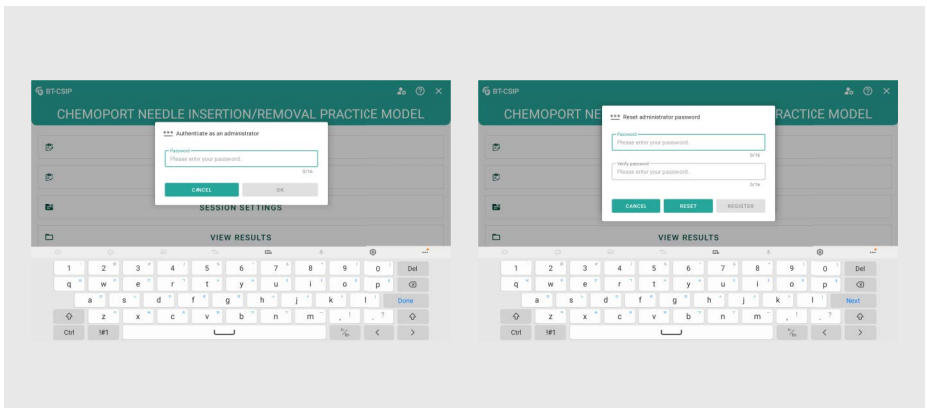

- On the administrator account settings page, you can choose whether to enable the administrator mode.
- If the administrator mode is not enabled, users without permission can also access session settings and evaluation results.
- The administrator password can be changed. If the password is lost, you can contact BT to receive a temporary password.

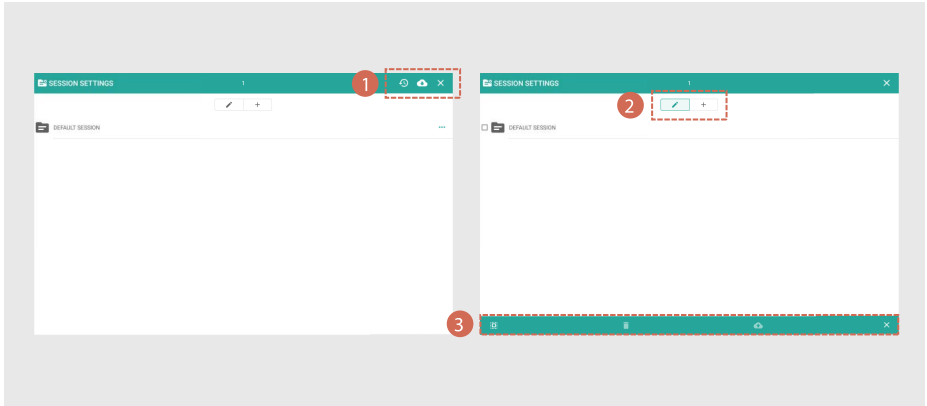

Session Settings

3-1. Creating and Editing Sessions





- A session is a collection of sequential practice steps that represent the procedures of a specific skill.
- Sessions can be newly created or existing pre-installed sessions can be modified for use.
- To delete or rearrange sessions, select the Edit icon.





① Icon

Icon	Description	Icon	Description
	Initialize Session		Import Session
	Exit		

② Icon

Icon	Description	Icon	Description
	Edit Session		Add Session

③ Icon

Icon	Description	Icon	Description
	Select all		Deselect
	Delete		Export Session
	Exit		

3-2. Copying a Session

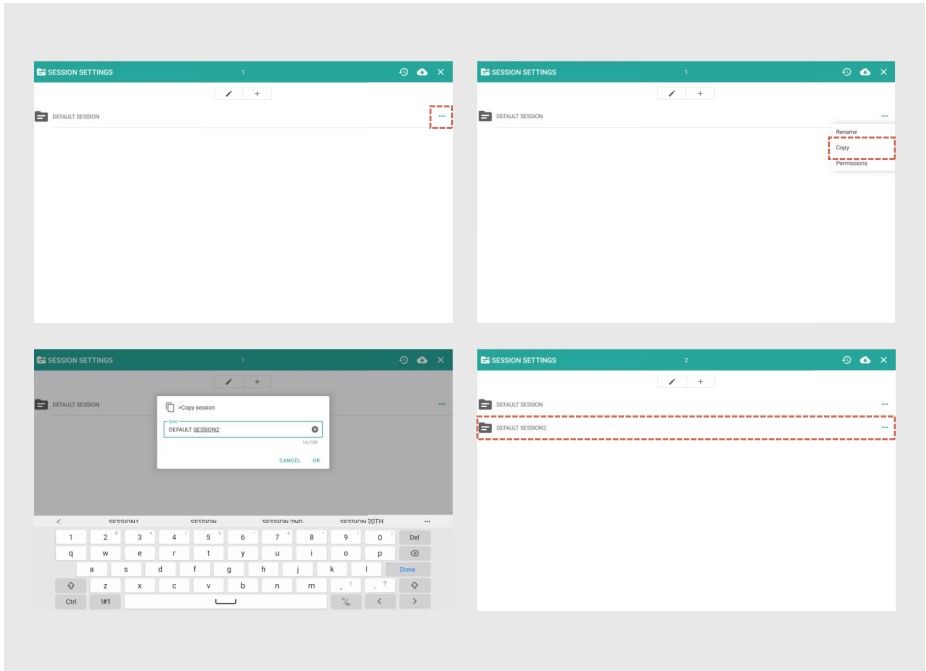

- The easiest way to create a new session is to copy an existing session and modify it to fit your purpose.
- Select the context menu of the session you want to copy, rename it, and use it accordingly.

3-3. Setting a permission for session

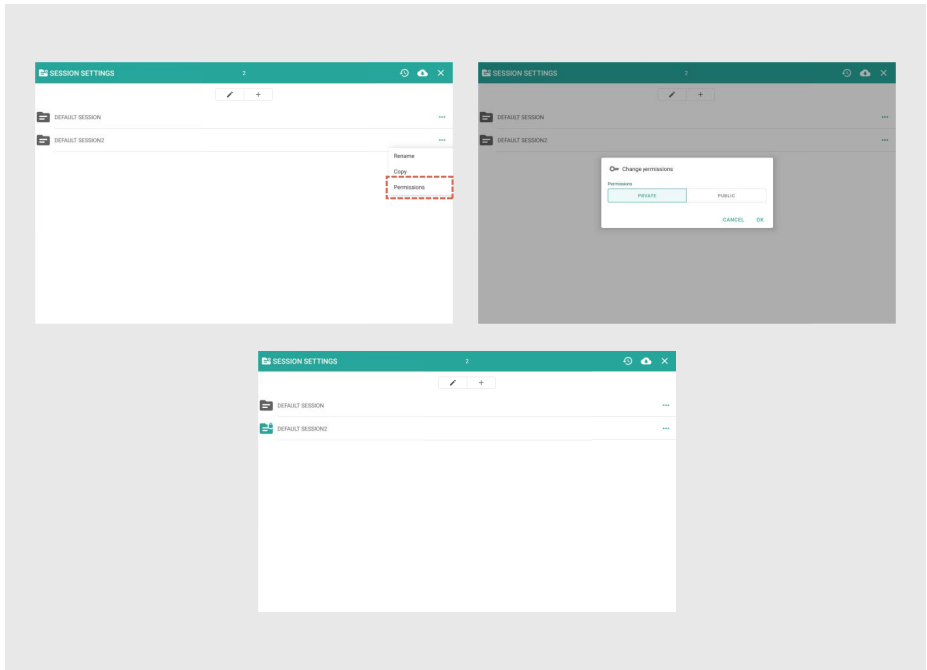

- You can choose whether to make a created session public or private.
- If the session is set to private, it cannot be used in Training Mode and will only be available in Evaluation Mode.

3-4. Exporting Sessions

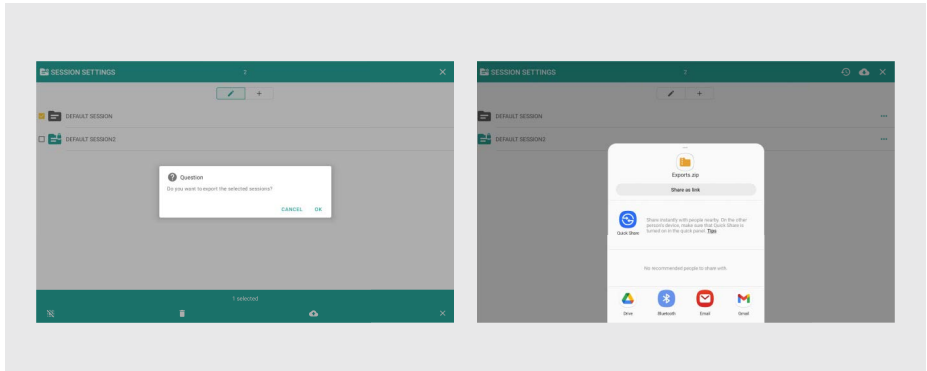

- Created sessions can be shared.
- In edit mode, select the session you want to share and click the export button.
- The session will be saved as one compressed file and can be sent to email or an app with data transfer functionality.

3-5. Importing Sessions

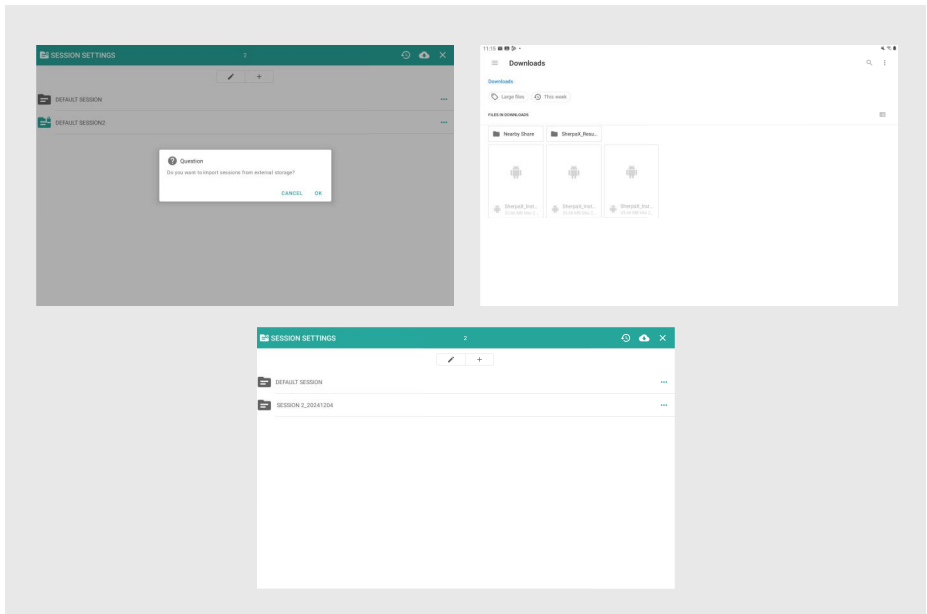

- Exported sessions can be added using the 'Import' function on the software.
- The session is saved in a compressed file, and large file sizes may take some time to transfer.
- If the session name is the same with an existing one, it will automatically be renamed and saved.

3-6. Creating Session Steps

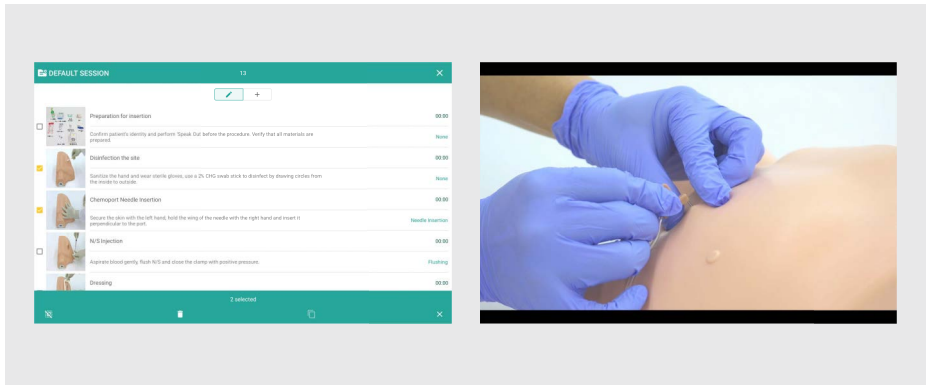

- Each step of a session consists of a title, description, image, video, and others representing each step.
- Select the Edit Mode to add, delete, or copy session steps.
- Use the drag-and-drop functionality in edit mode. To change the order of steps.
- Click the thumbnail image of a session step to play the associated video or view the original image.

3-7. Configuring Session Steps

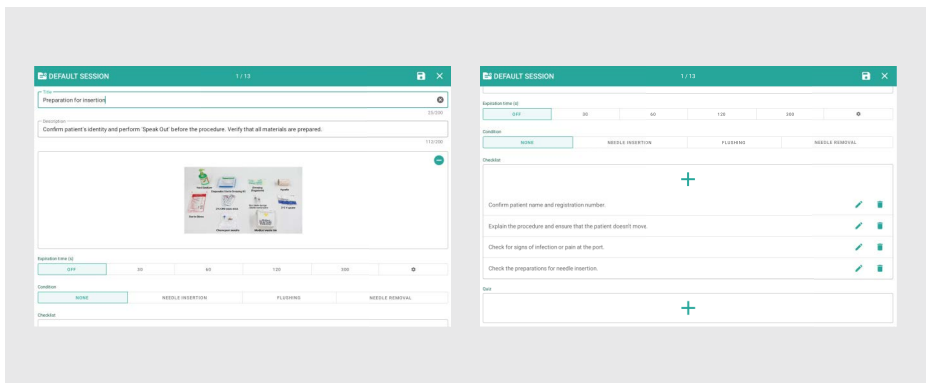

- Each step of a session consists of a title, description, image, video, and others representing each skill.
- To limit the practice time for each step, you can set a time limit, allowing the system to automatically move to the next step.
- Additionally, you can configure conditions to determine whether to proceed to the next step after performing actions such as needle insertion, infusion, or needle removal.

3-8. Adding Photos and Videos

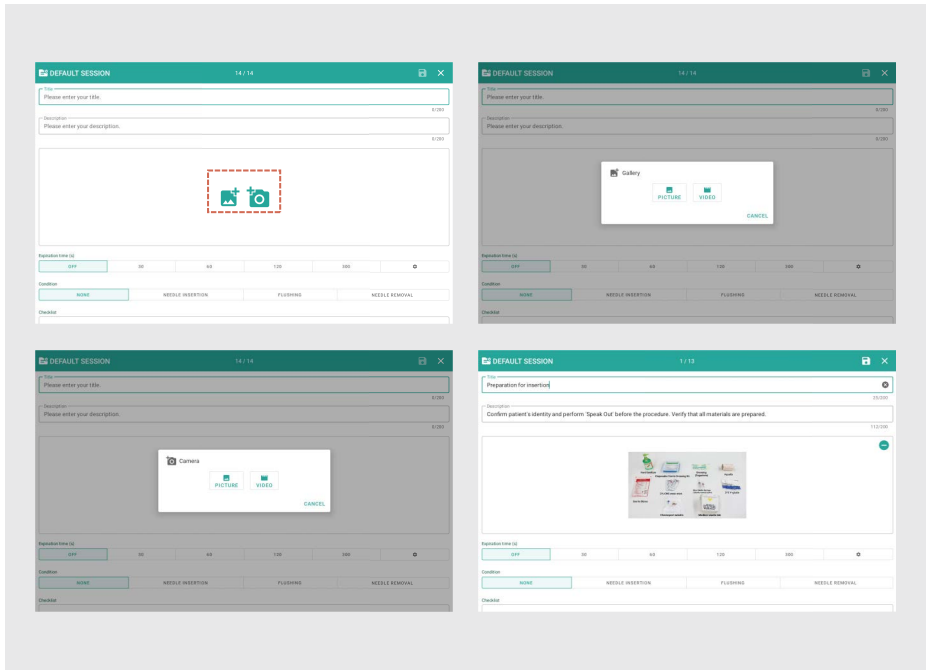

- Photos and videos can be added to create new training curriculums.
- You can either retrieve existing photos and videos from the gallery or use the camera mounted on the tablet to record practice videos and add them.
- It is recommended to use the tablet in landscape mode when taking practice photos and recording videos.

3-9. Creating a Checklist

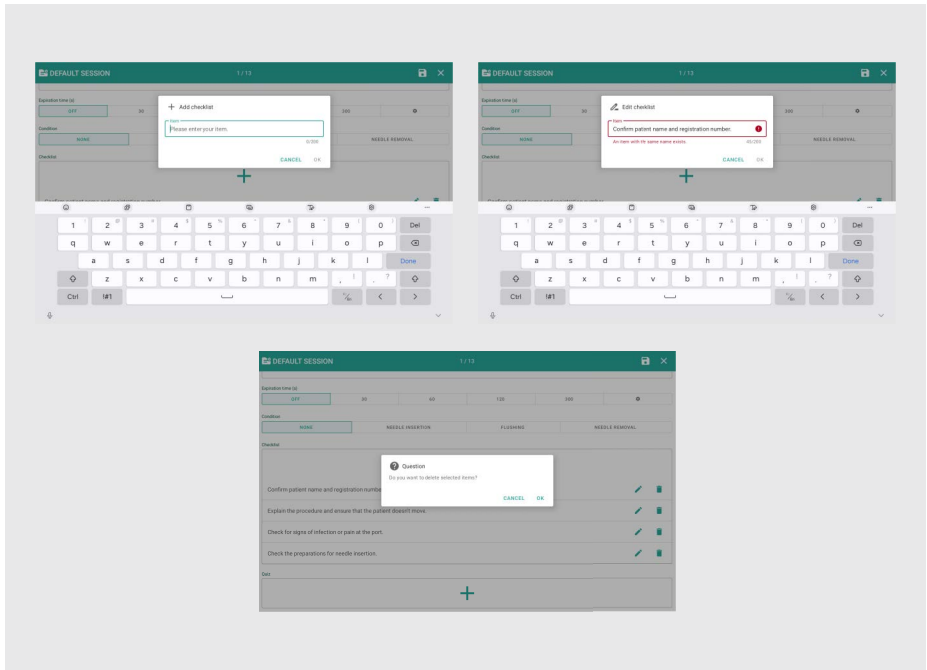

- Create a checklist to outline important aspects of each practice step and reflect the results.
- To delete or reorder the created checklist, you can use the drag-and-drop function.

3-10. Creating a Quiz

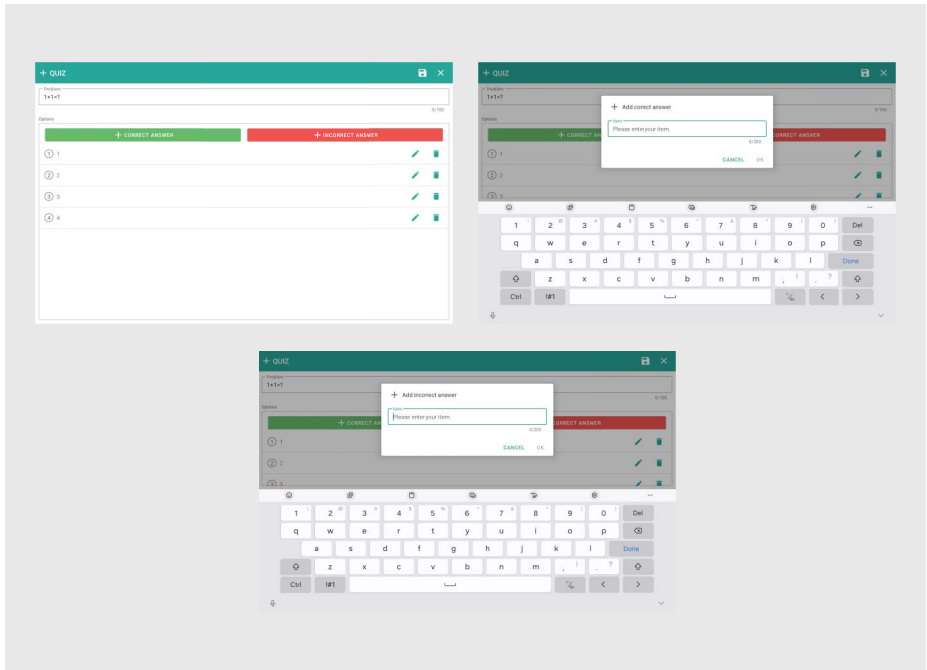

- You can create a quiz to check whether the trainees understand the practice steps well and reflect the results.
- A quiz can be created by defining the questions and adding correct and incorrect answers.
- To delete or reorder the created quiz, you can use the drag-and-drop function.

Training Mode

4-1. Setting Training Mode

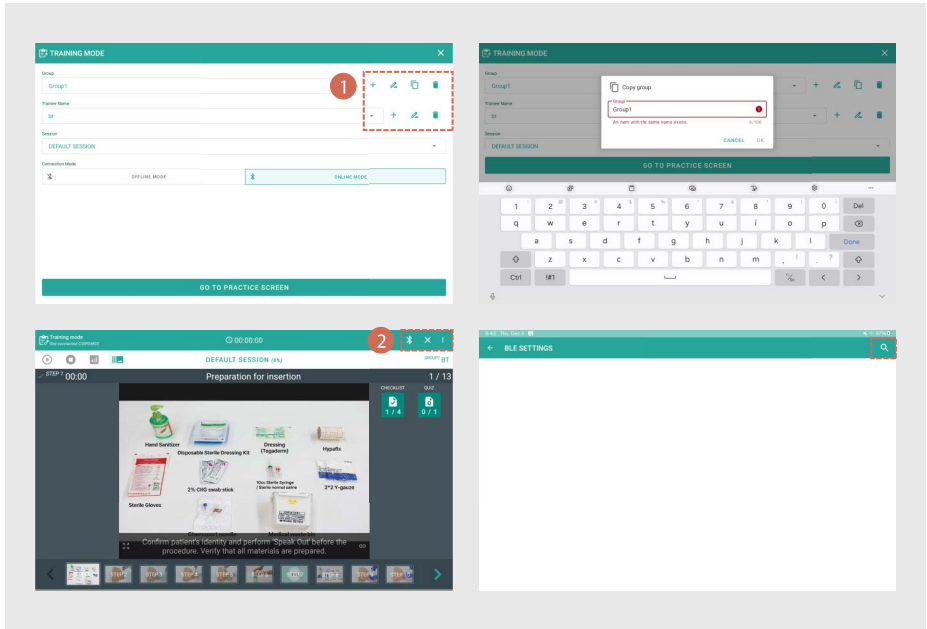

- To start training mode, you need to select trainees and a session.
- The trainee list can be managed by creating groups, with options to add, copy, delete, and rename entries.
- In training mode, only public sessions can be used.
- If the manikin is not available, you can use the offline mode.

① Icon

Icon	Description	Icon	Description
	Add		Rename
	Copy		Delete

② Icon

Icon	Description	Icon	Description
	Connect bluetooth		Reconnect Bluetooth

4-2. Running Training Mode

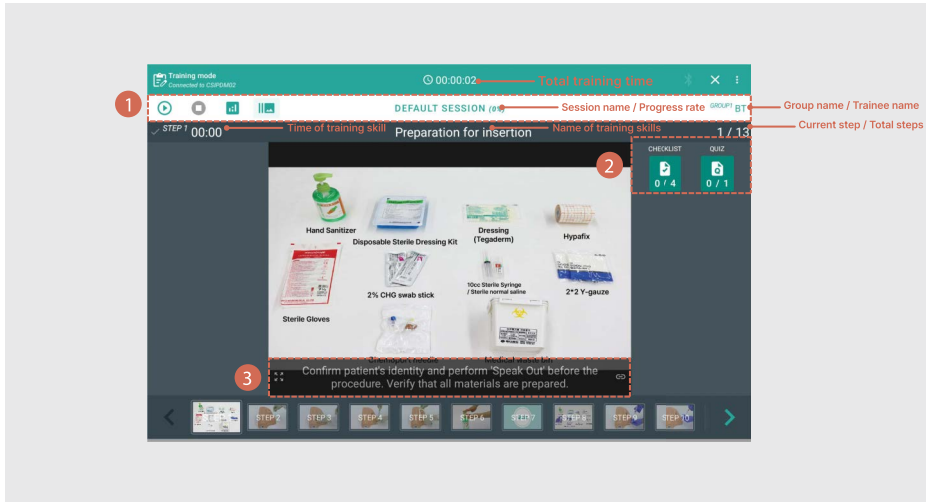

① Icon

Icon	Description	Icon	Description
	Start		Stop
	Results		Progress window for training steps
	Preview the Session		

② Icon

Icon	Description	Icon	Description
	Checklist		Quiz

③ Icon

Icon	Description	Icon	Description
	Watch on other Platforms		Change the Display Resolution

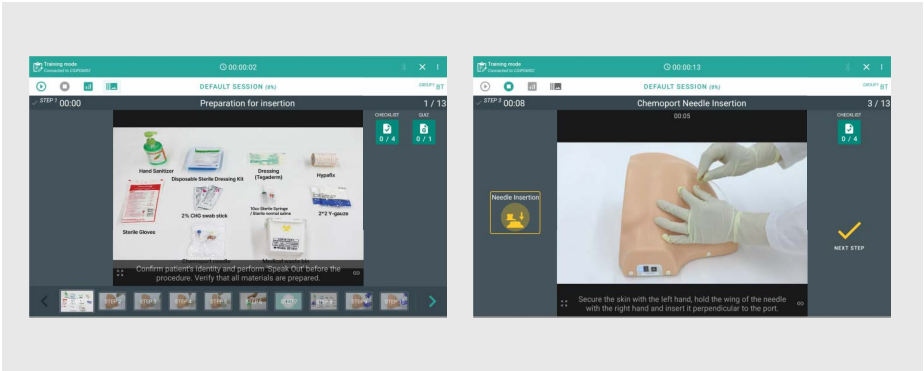

- The purpose of training mode is to repeat the selected session to improve the trainees' understanding and execution ability of the session.
- In training mode, you can use the progress window at the bottom to revisit and practice previously completed steps.
- In offline mode, you can manually perform actions like needle insertion, flushing, and needle removal by clicking the corresponding icons.

4-3. Watching videos

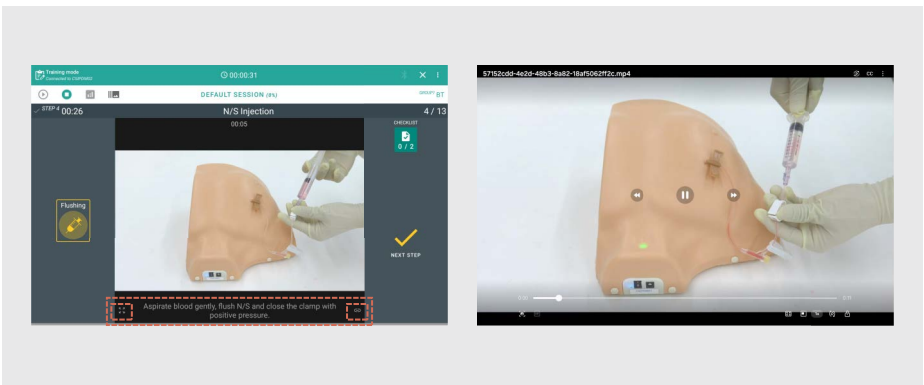

- Videos explaining the practice procedures can be provided as images or videos.
- You can click on the practice video to pause or restart.
- Subtitles can be toggled on or off, and the video can also be viewed using other photo and video apps installed on the tablet.

4-4. Preview sessions

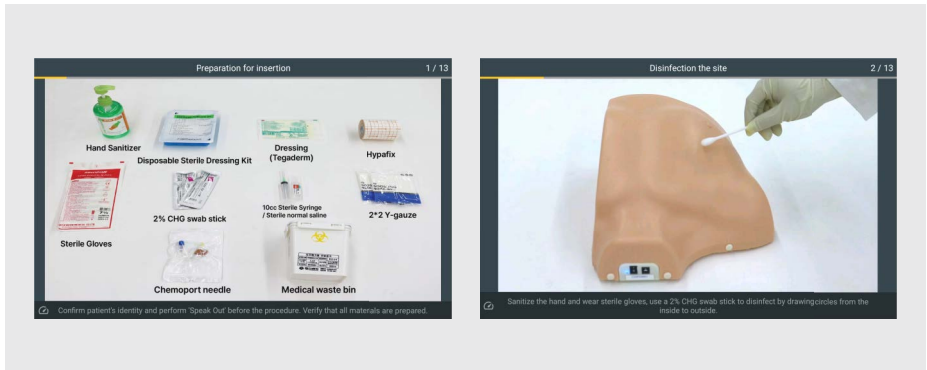

- The session preview feature allows you to view each step of the session in a short video format.
- The short video can be paused and restarted, and the play speed can also be adjusted.

4-5. Checklist

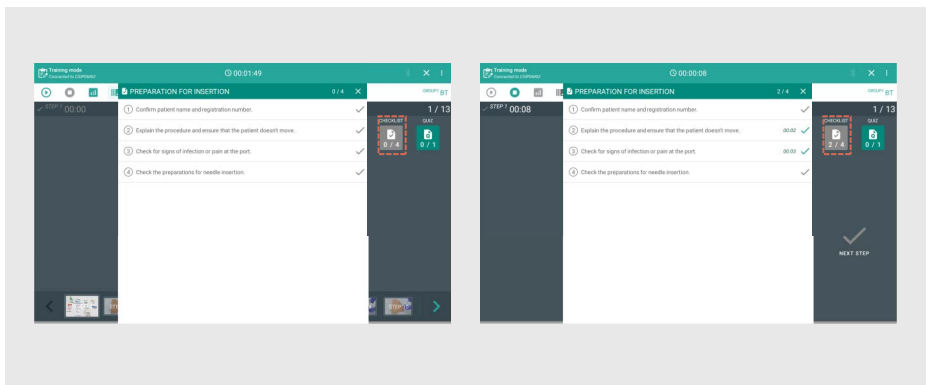

- For each step of the session, important parts can be created as a checklist, allowing trainees to check items as they proceed with the practice.
- The result of checklist is displayed on the training screen in the format "Completed Count/Total Count," along with the execution time and whether each item was checked.

4-6. Quiz

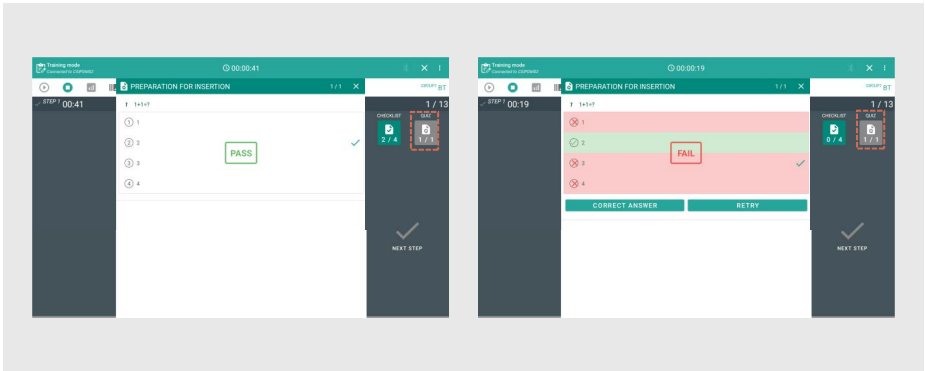

- Trainees can be assessed on their understanding of the corresponding practice step by solving quizzes.
- Quizzes are displayed in a "PASS/FAIL" format, and trainees can retry or confirm the correct answers.
- The quiz results are shown on the practice screen in the format "Completed Count/Total Count."

4-7. Result

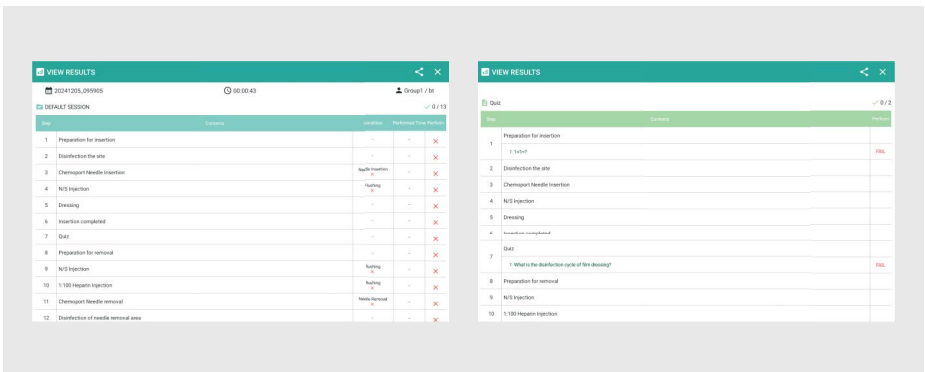

- The results of training mode consist of the training results for each step, checklist results, and quiz results.
- Through the training results for each step, you can check whether conditions were met, the step execution time, and whether the step was completed.
- Checklist results are displayed for each step in the format (✓ / ✗) to indicate completion. Quiz results are displayed in the format "(PASS / FAIL)."
- Training results cannot be saved but can be shared using the sharing function to export.

Assessment Mode

5-1. Setting Assessment Mode

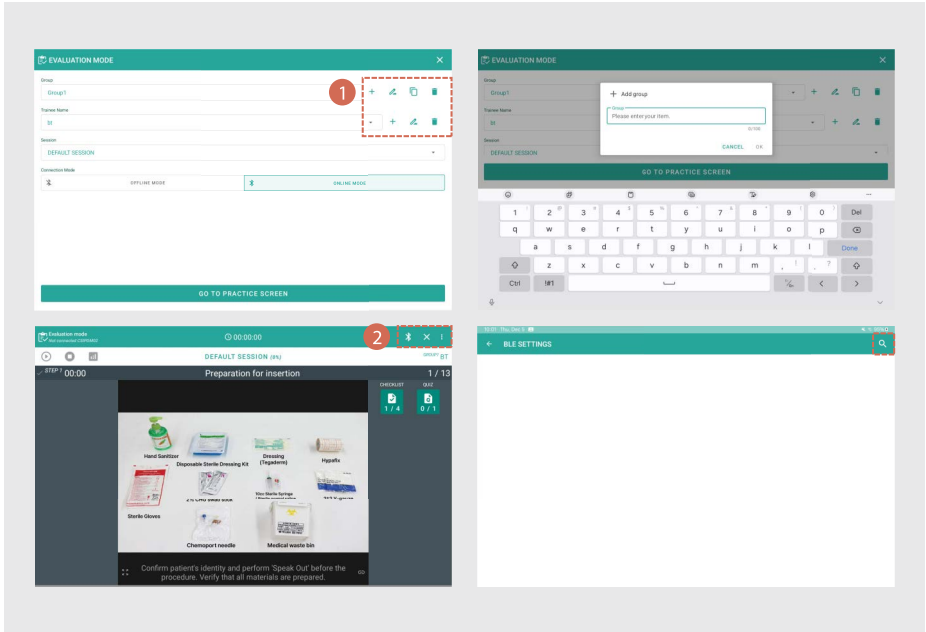

- To start assessment mode, you need to select trainees and a session.
- The trainee list can be managed by creating groups, with options to add, copy, delete, and rename entries.
- In assessment mode, both public and private sessions can be selected.
- If the manikin is not available, you can use the offline mode.

① Icon

Icon	Description	Icon	Description
	Add		Rename
	Copy		Delete

② Icon

Icon	Description	Icon	Description
	Connect bluetooth		Reconnect Bluetooth

5-2. Running Training Mode

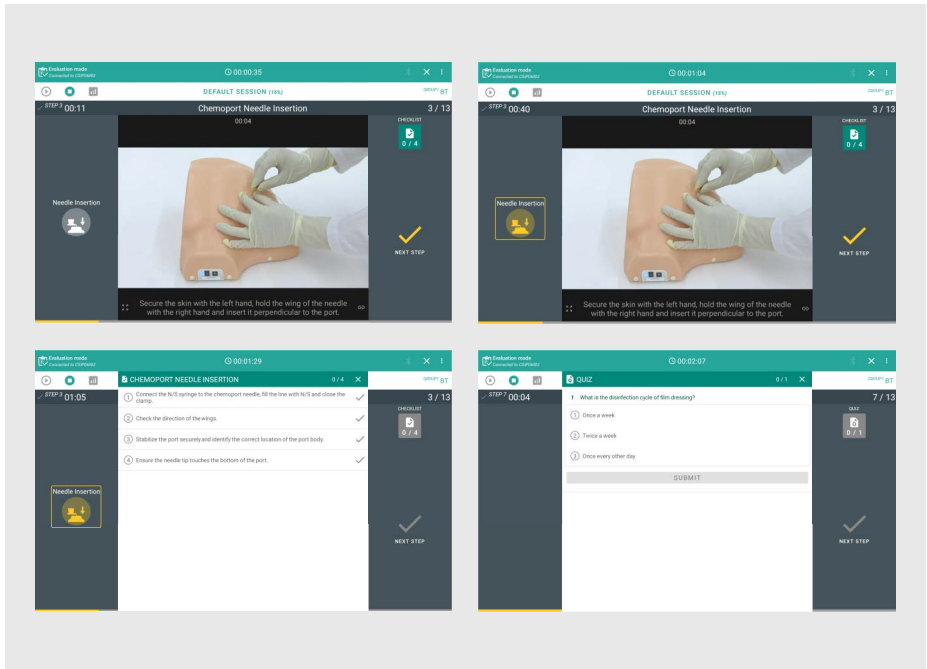

- The purpose of assessment mode is to assess, compare and analyze the performance abilities of trained trainees through repeated practice.
- Unlike training mode, once each step is completed, you cannot return to the previous step, and quiz answers and results cannot be reviewed.
- In offline mode, you can manually perform actions like needle insertion, flushing, and needle removal by clicking the corresponding icons.

Results

6-1. Directory of Group Results

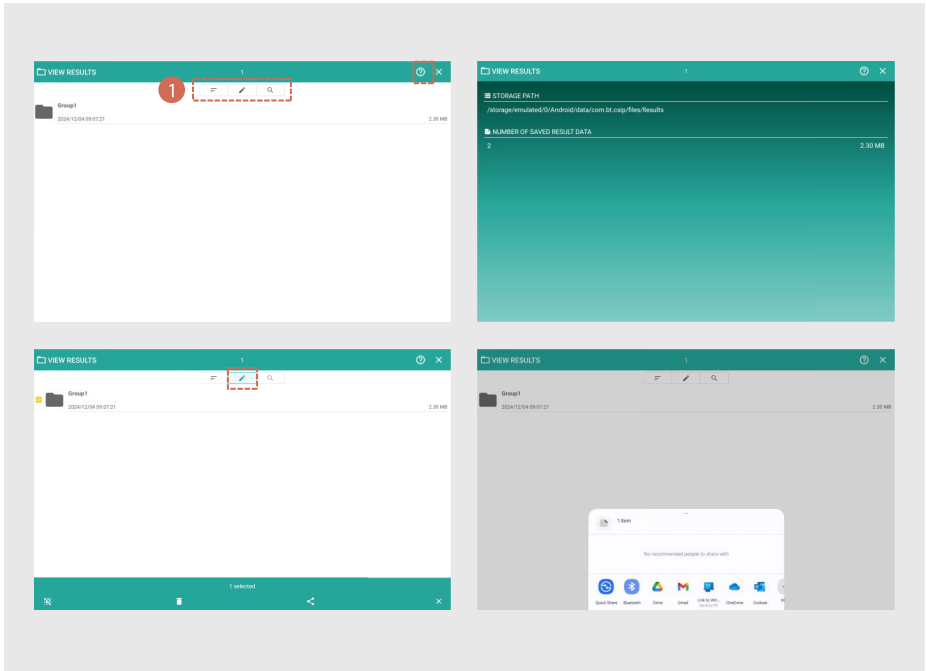

- Assessment results are organized and stored by group.
- You can search for or sort group folders to review the desired ones.
- By opening the directory information window, you can check the storage path and the number of results stored in that location.
- In edit mode, you can delete group folders or export the stored results externally.

🔍 Icon

Icon	Description	Icon	Description
	Sort Settings		Edit
	Ascending Sort		Descending Sort
	Search		

6-2. Directory of Session Results

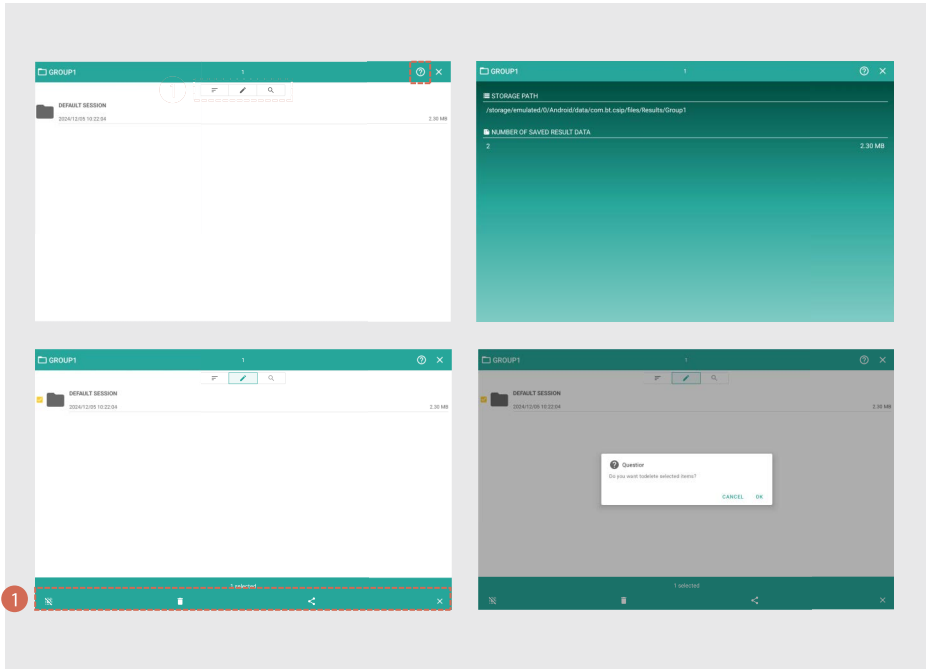

- When you click the group folder, the directory of session results will appear.
- You can search for or sort session folders to review the desired ones.
- By opening the directory information window, you can check the storage path and the number of results stored in that location.
- In edit mode, you can delete session folders or export the stored results externally.

① Icon

Icon	Description	Icon	Description
	Select all		Deselect
	Delete		Export Results
	Exit		

6-3. Directory of Trainee Results

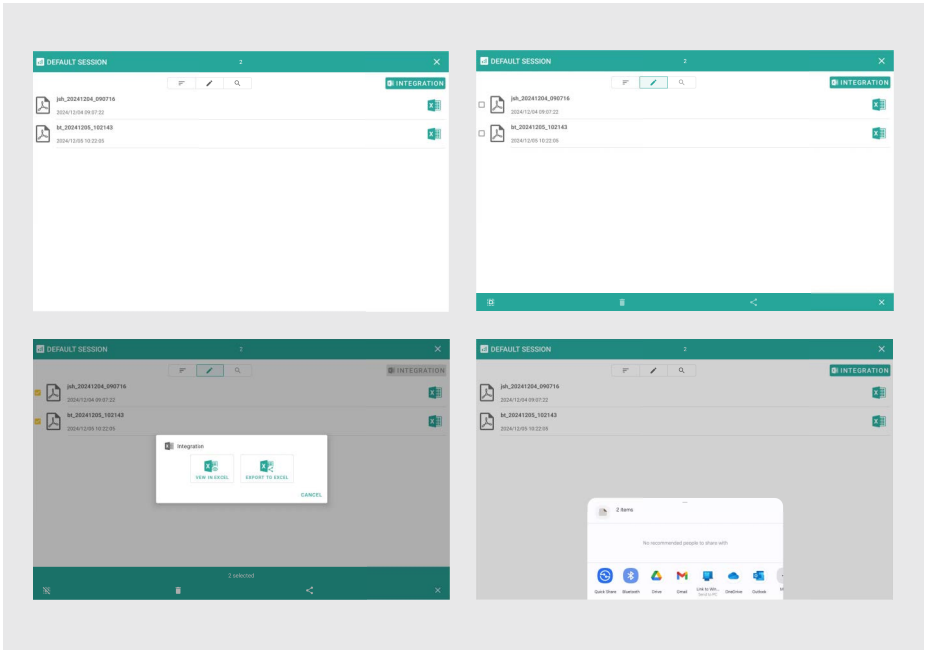

- When you click the session folder, the directory of trainee results will appear.
- You can search for or sort trainee results to review the desired ones.
- In edit mode, you can delete trainee result files or export the saved results in PDF and Excel formats.
- If a printer is connected to the tablet in use, the saved results can be printed.

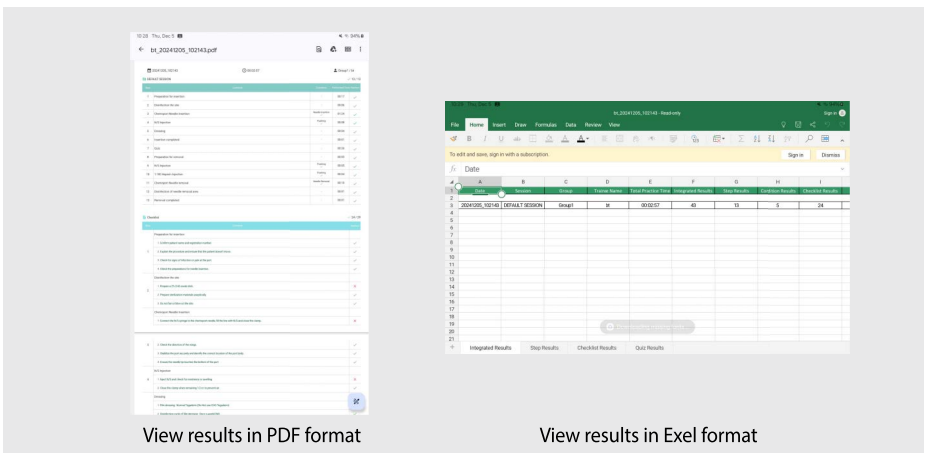

View results in PDF format

View results in Exel format

6-4. Directory of Trainee Results : Check the integrated result

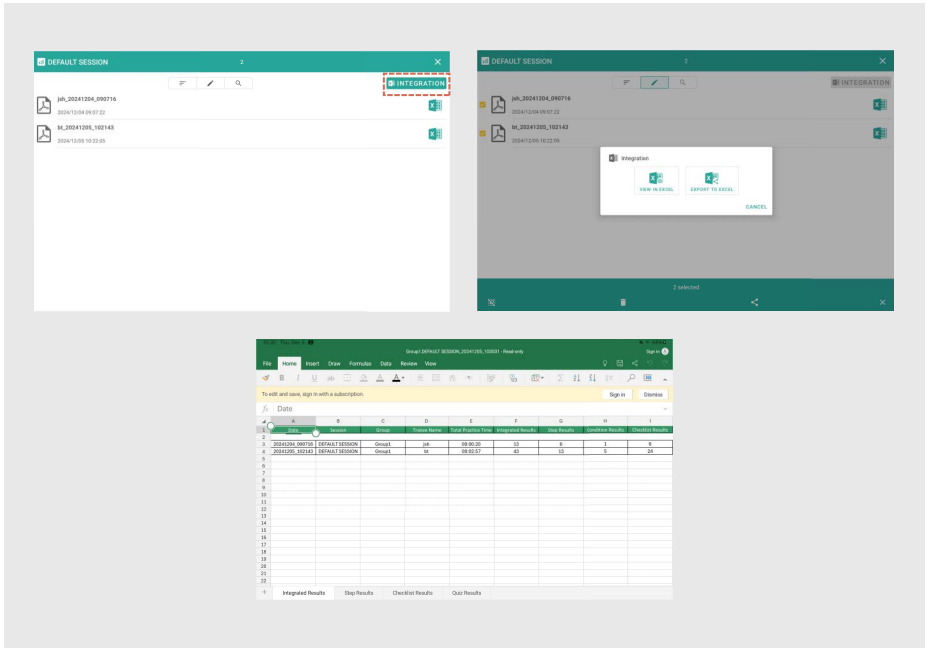

- The saved evaluation results can be integrated in Excel format for a review or shared to the desired location.
- In edit mode, you can integrate or share only the selected results.

BT-CSIP

Chemoport Injection Training Simulator

A-313, Samsung Techno-valley, 140, Tongil-ro,
Deogyang-gu, Goyang-si, Gyeonggi-do, 10594, Republic of Korea

Homepage: www.btinc.co.kr / E-mail: bt@btinc.co.kr
Tel: +82-2-2038-2903, +82-51-903-1144 / Fax: +82 303-3130-0607

Copyright(c) BT Inc. All rights reserved.