

How to SET UP the TRAUMA KIT

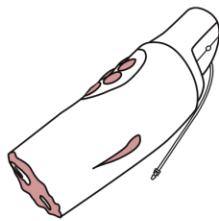

Amputated left leg
module (bleeding)

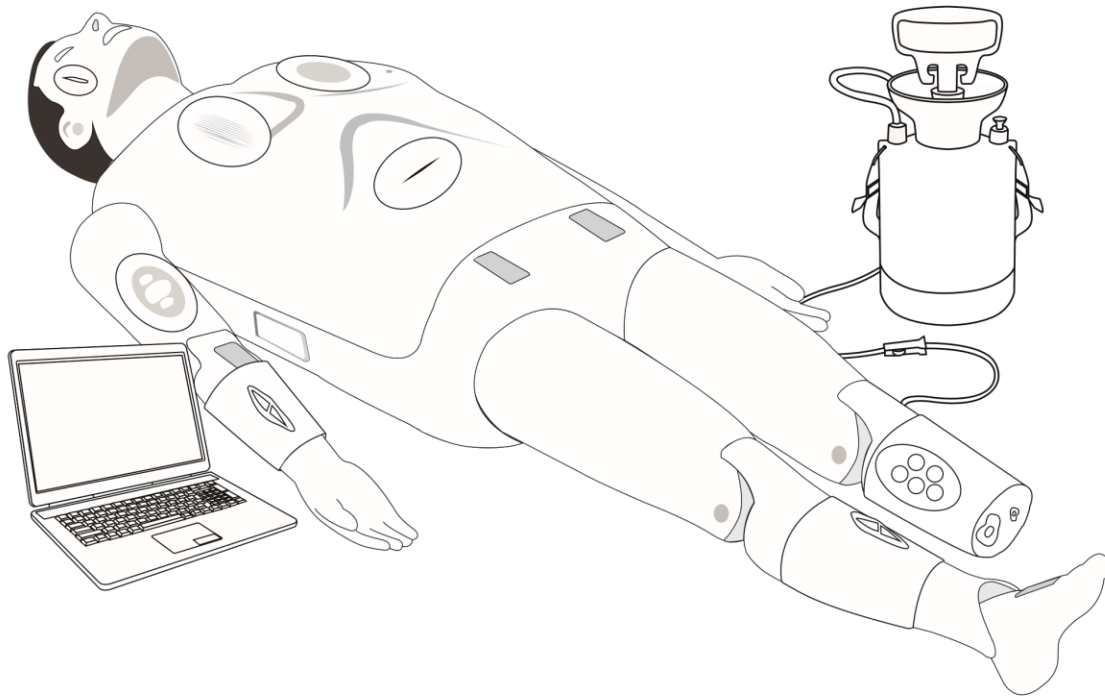
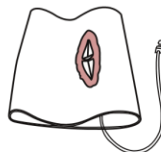

Open fractured right leg
module (bleeding)



Open fractured right arm
module (bleeding)



Laceration



Burn



Open fracture



Abrasion



Bruise

Attachable wound
module (5 cases)



Laceration



Burn



Open fracture



Abrasion



Bruise

Attachable wound
module small size(5 cases)

I. Amputated left leg module (bleeding)

a. Installation Guide for the Amputated Left Leg Module

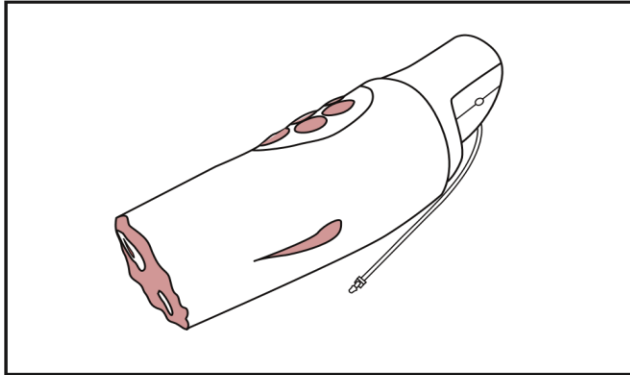

Remove the normal leg and install the amputated left leg module.

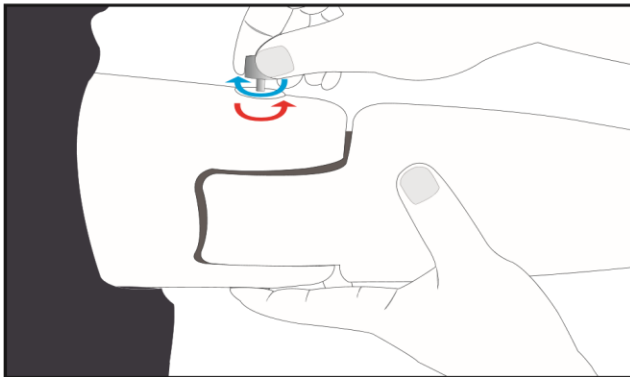
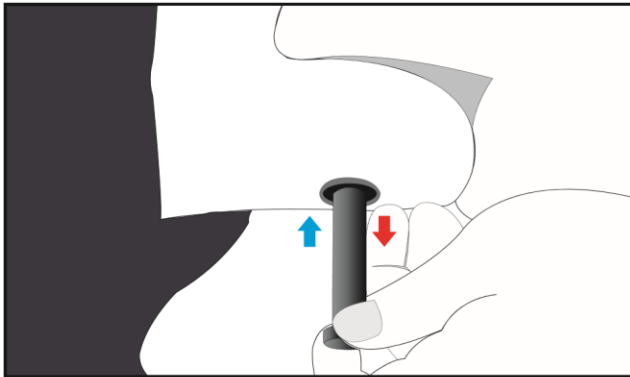

※ Assemble/disassemble by turning the knob bolt by hand.

b. How to connect the bleeding air pump

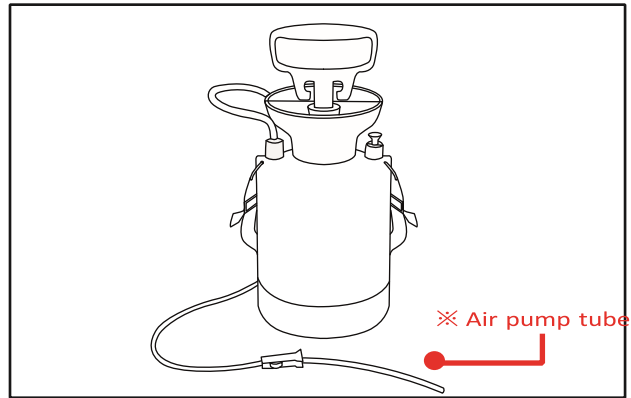

Prepare an air pump for bleeding.

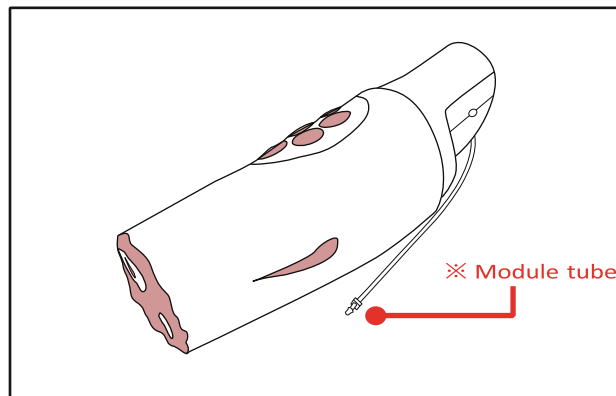

Prepare the module tube of the amputated leg.

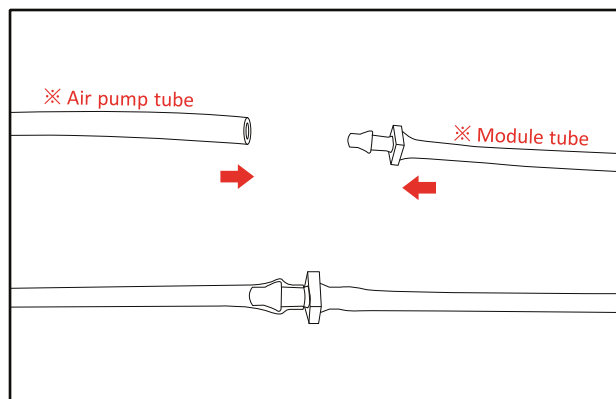

Connect the Air pump tube with the Module tube.

c. Bleeding and hemostasis

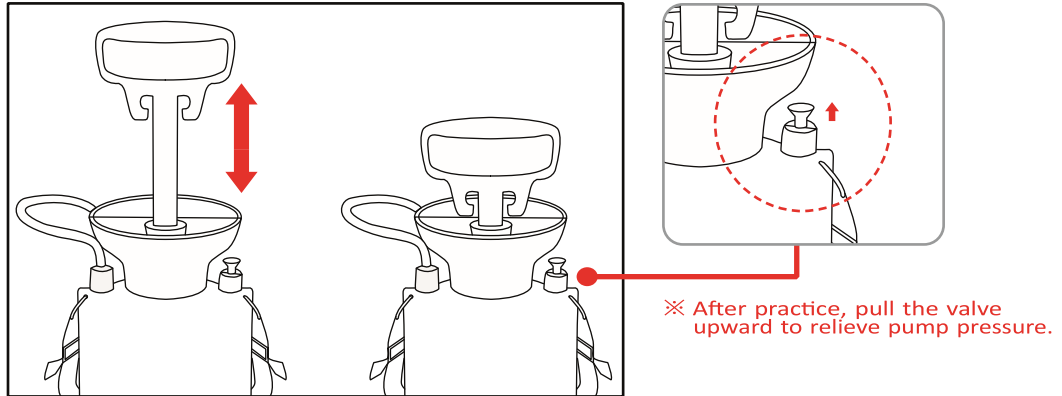

Pump the air pump handle 10-15 times.

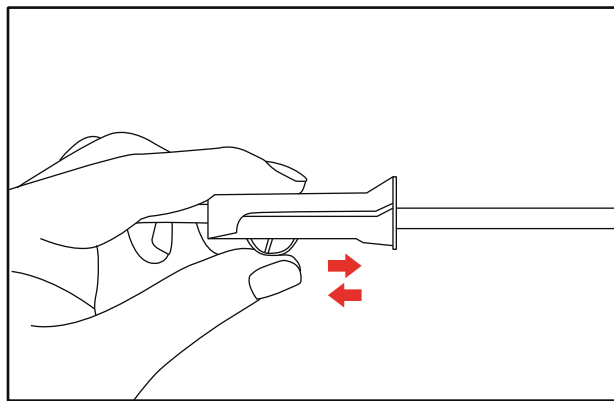

Control the amount of bleeding with a roller clamp.

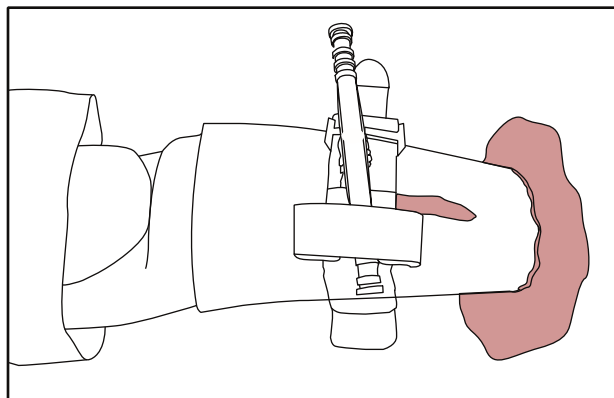

If bleeding occurs, stop it by using a twist tourniquet.

- II. Open fractured right leg module (bleeding)
 - a. How to install the open fractured right leg module

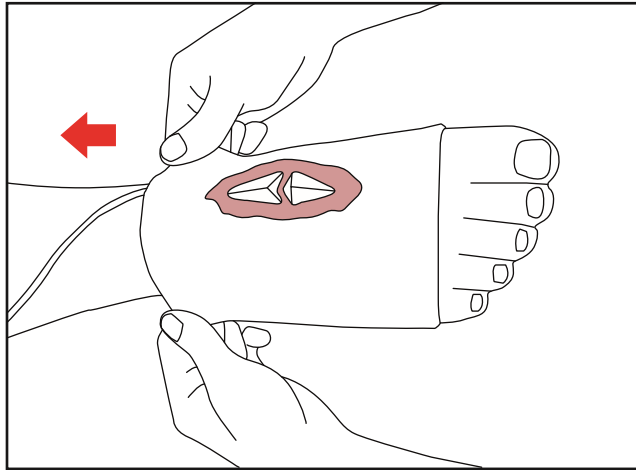

Attach the open fractured leg module to the normal leg.

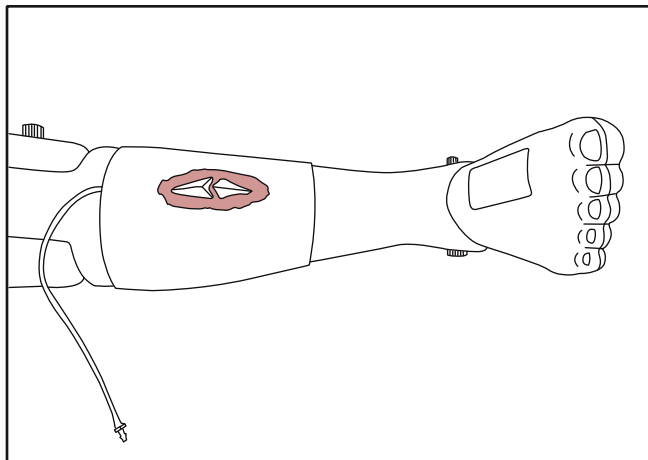

b. How to connect the bleeding air pump

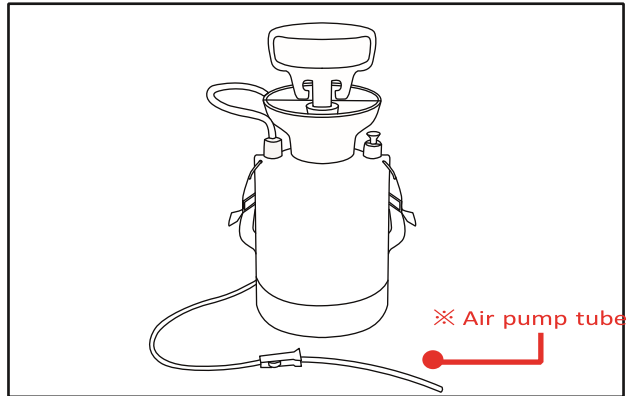

Prepare an air pump for bleeding.

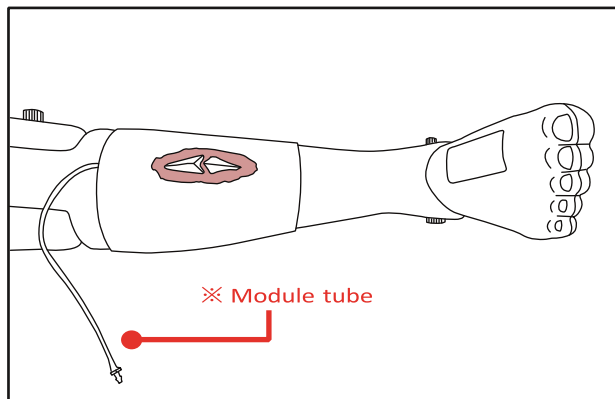

Prepare the tube for the leg module.

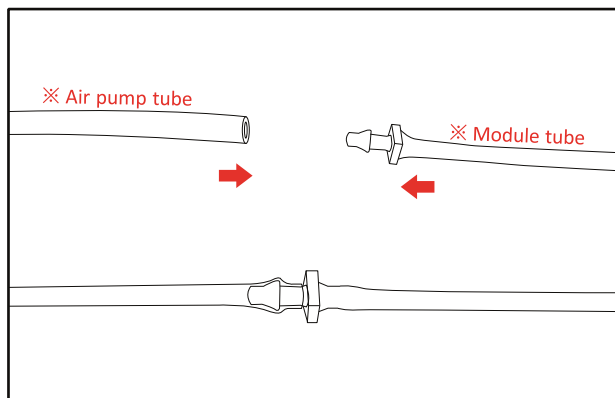

Connect the Air pump tube with the Module tube.

c. Bleeding and hemostasis

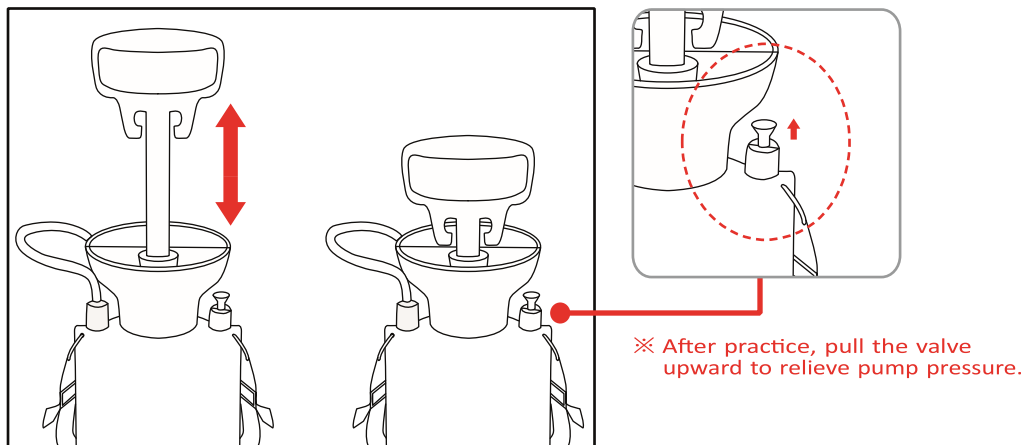

Pump the air pump handle 10-15 times.

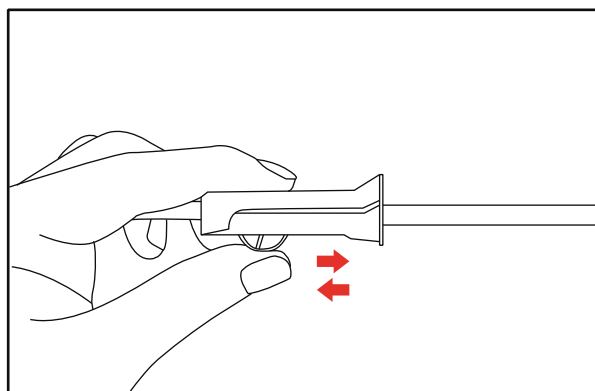

Control the amount of bleeding with a roller clamp.

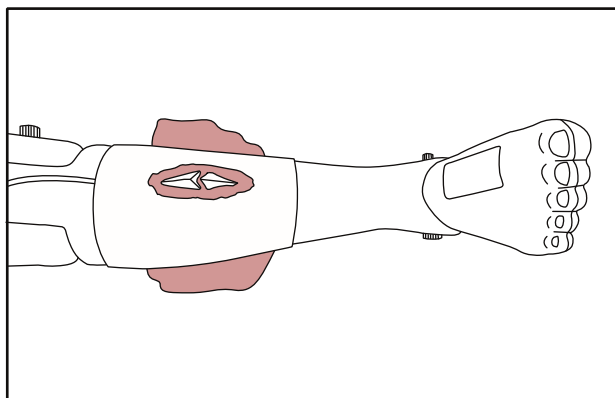

If bleeding occurs, use gauze and a bandage to stop the bleeding.

- III. Open fractured right arm module (bleeding)
 - a. How to install open fractured right arm module

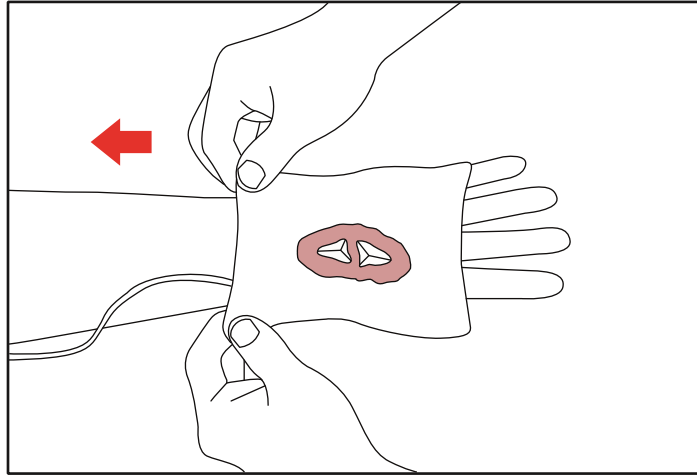

Place the open fractured right arm module on the right arm.

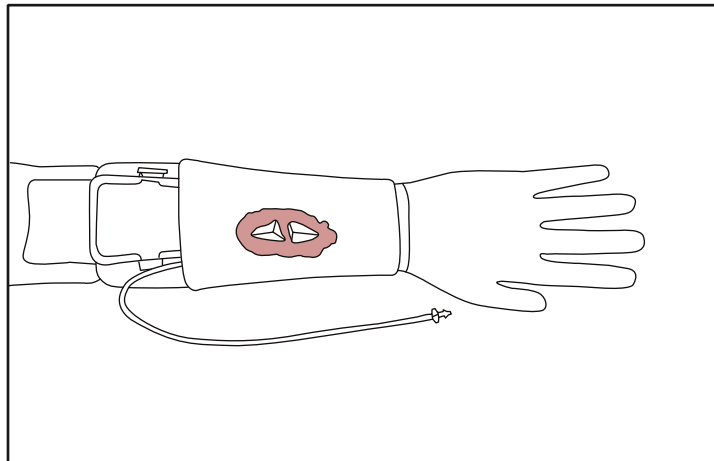

b. How to connect the bleeding air pump

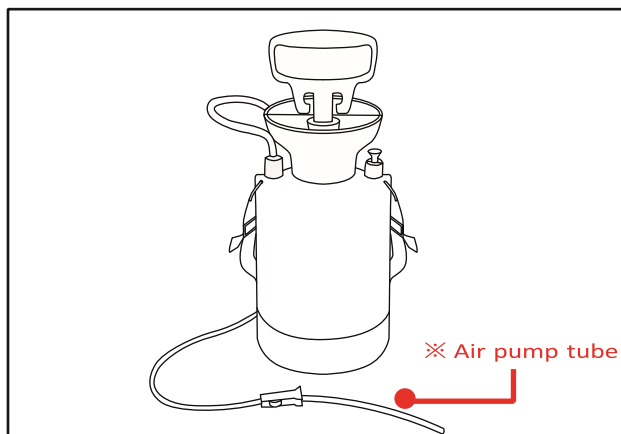

Prepare and air the pump for bleeding

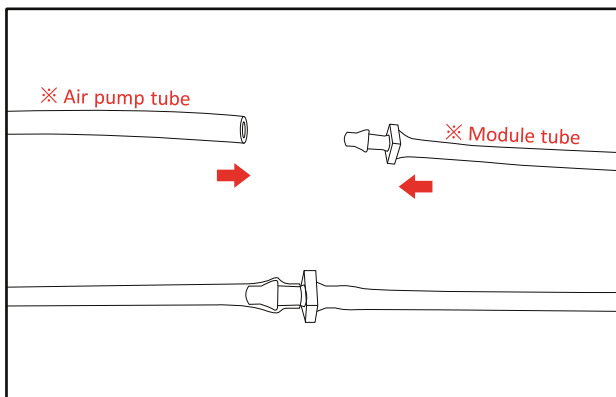
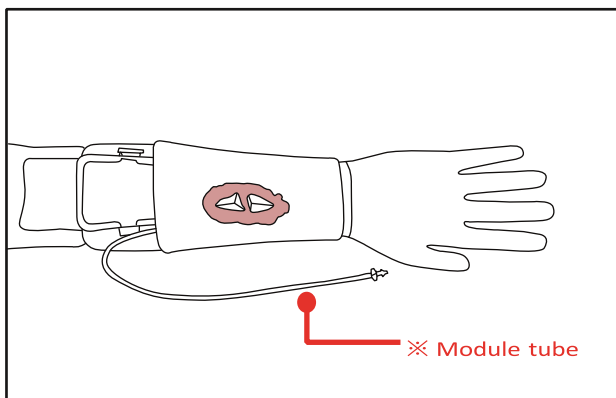

Connect the air pump tube with the module tube.

c. Bleeding and hemostasis

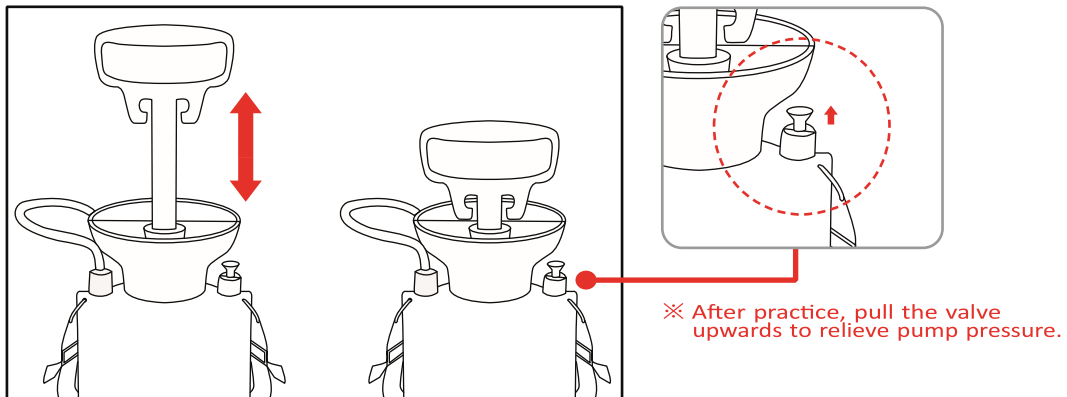

Pump the air pump handle 10-15 times.

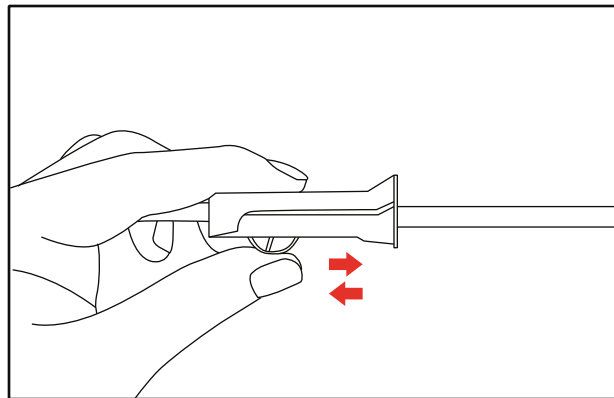

Control the amount of bleeding with a roller clamp.

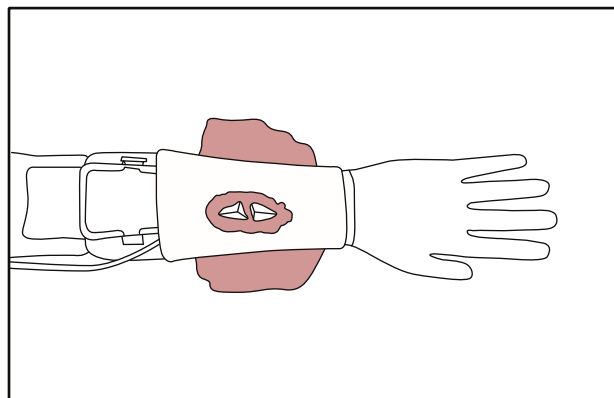

If bleeding occurs, use gauze and a bandage to stop it.

IV. Attachable wound module (5 modules)

a. How to attach an attachable wound module

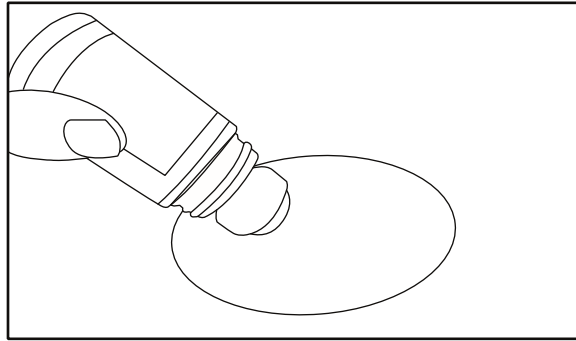

Apply the human body adhesive evenly to the back of the wound module.

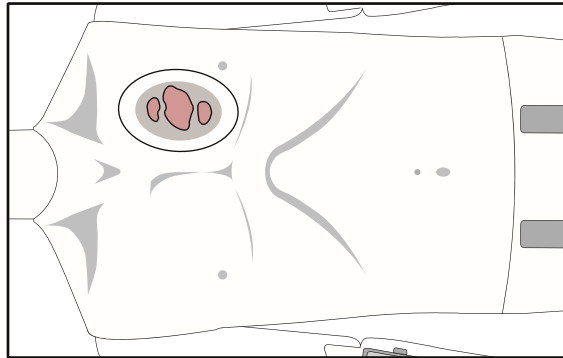

Attach the wound module to the desired location.

b. How to clean after detaching the wound module

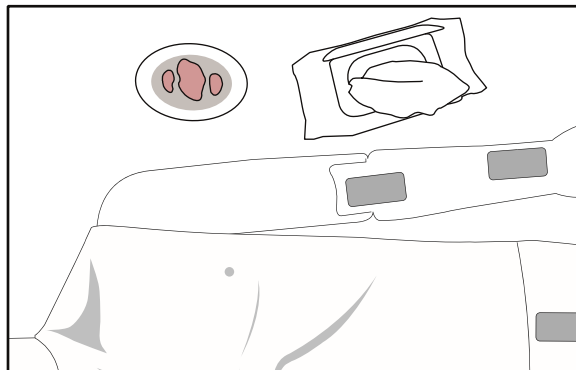

Wipe the attached area and the back of the wound module with a wet tissue/towel.

- V. Attachable wound module small size (5 modules)
- a. How to attach an attachable wound - small size

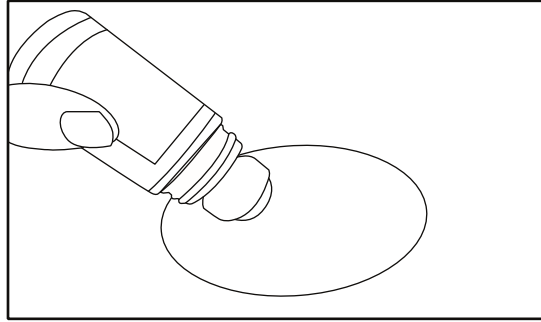

Apply the human body adhesive evenly to the back of the wound module.

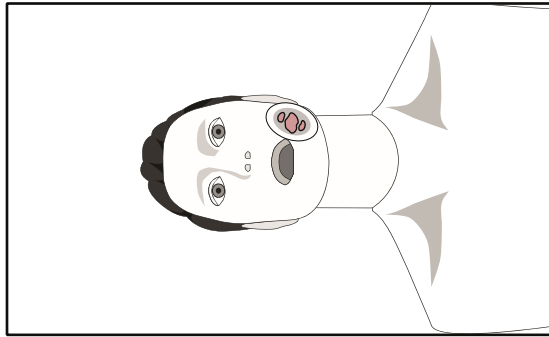

Attach the wound to the desired location.

- b. How to clean after detaching the wound module

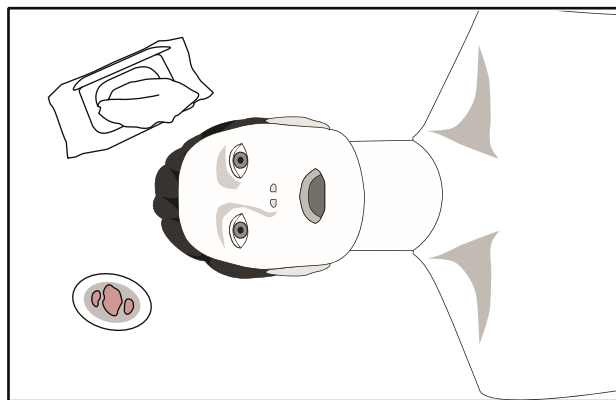

Wipe the attached area and the back of the wound module with a wet tissue/towel.